

T01 Partial extension undermount slides installation

Drawer installation dimensions

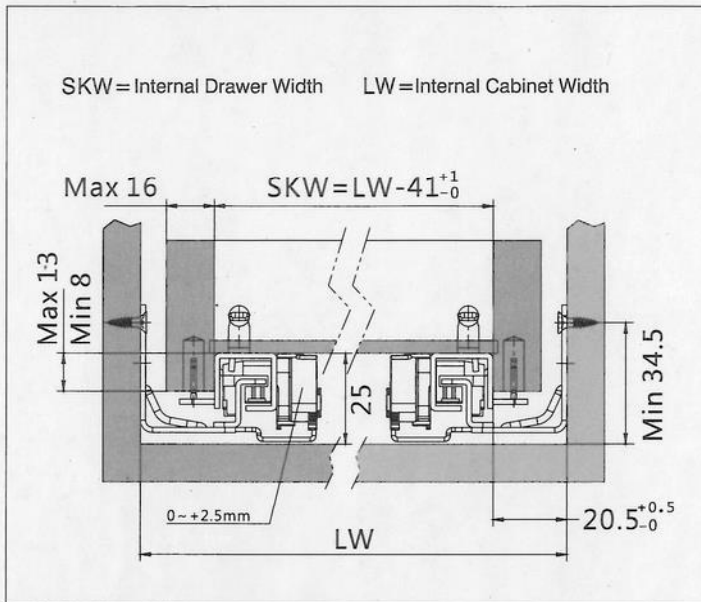

Drawer preparation

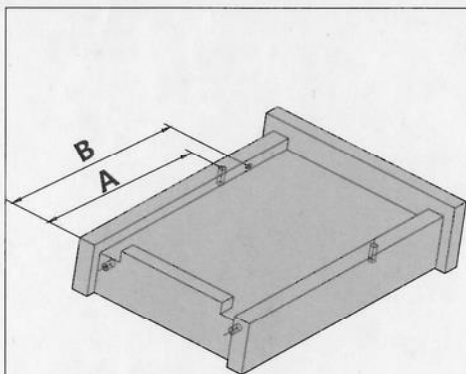

NL (mm)	A (mm)	B (mm)
250	196	228
270	196	228
300	211	243
350	236	268
400	261	293
450	286	318
500	311	343
550	341	373
600	366	398

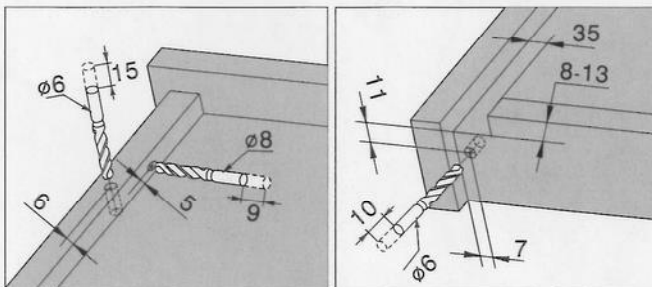

Screw Positions of the Slides

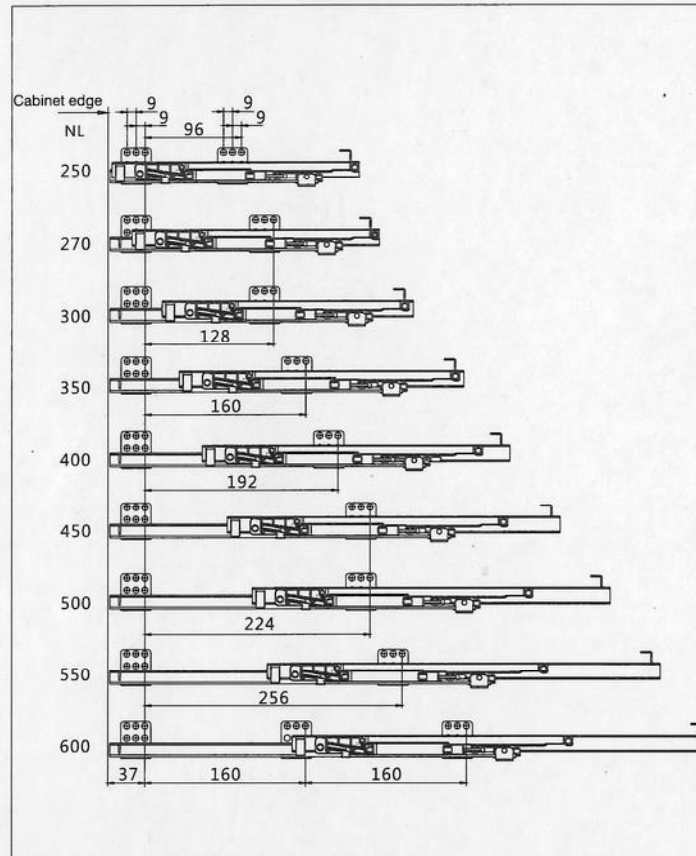

Drawer installation dimensions

NL = Nominal Slide Length

LT = Internal cabinet Depth

Standard drawer $LT_{min} = NL + 3$

Inner drawer $LT_{min} = NL + 21$

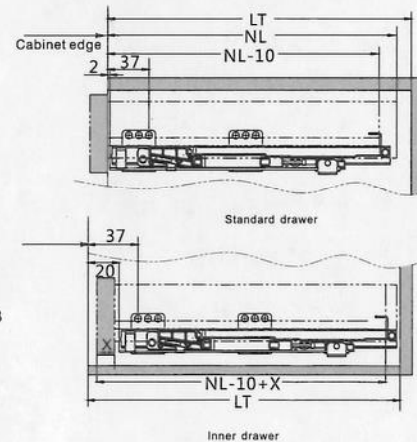

Drawer assembly and removal

Installation

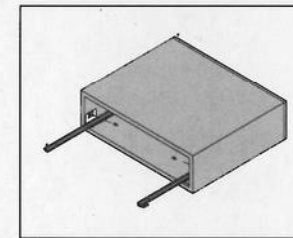

Fix the slide onto the cabinet

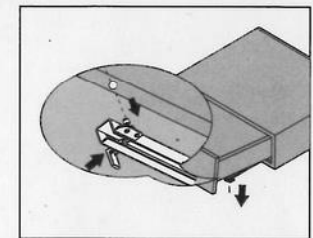

Pull out the drawer member of the slide, then lay the drawer onto the slide. Press the locking pin into the drawer side to lock the position of the drawer.

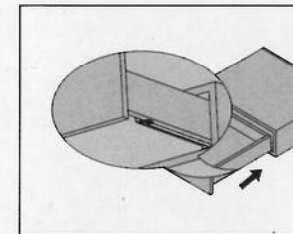

Push the drawer into the cabinet and finished

Removal

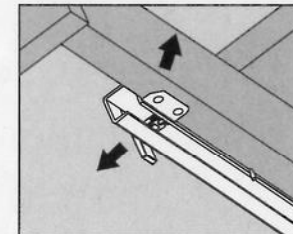

For removal, pull out the locking pin from the drawer side.

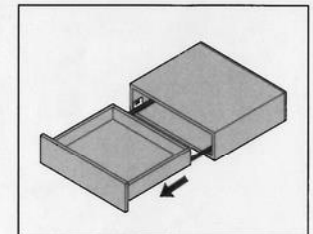

Lift the drawer and pull it out from the cabinet

DTC
Global Quality Benchmark

Website: www.dtcetc.com