



PK2



SHELF  
SUPPORTS





# SYMBOLS AND FINISHES LEGEND

## SYMBOLS

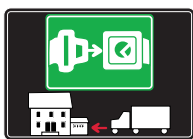

= SHELF SAFELY LOCKED DURING TRANSPORTATION AND AT HOME.



= ANTI-TURNOVER LOCKING SYSTEM



= NORMS / PATENTS



= PHILLIPS / POZIDRIV



= WITH BUFFER



= PART NO.



= BLADE SLOT



= WITH MAGNET



= PCS. PER PACKAGE



= COMBI SLOT



= NEWTON



= CAPACITY LOADING



= HEXALOBULAR SOCKET



= FRICTION



= WOOD / GLASS THICKNESS



= COUNTERSUNK HEAD



= AUTOMATIC



= HOLE DIAMETER



= PAN HEAD



= DROP DOWN



= DIAMETER



= FLANGE HEAD



= STANDARD HINGE



= LENGTH



= FLAT HEAD



= KIMANA HINGE



= HEIGHT



= TRILOBULAR SCREW



= FLAP HINGE



= RIGHT VERSION



= SELF-TAPPING SCREW



= WITH SPRING



= LEFT VERSION



= EURO THREAD



= WITHOUT SPRING



= SETTING CODE



= METRIC THREAD



= REVERSED SPRING



= PCS. PER PAD



= PRE-INSERTED SCREW



= PRE-INSERTED SCREW AND SPREADING BUSH



= CUT ON REQUEST



= SELF ADHESIVE



= WITH FLANGE

NOTE: Printing errors and omissions may exist despite our best efforts to ensure accuracy. We reserve the right to alter specifications without notice.

## MATERIALS

<b>ZA</b> = Zinc Alloy	<b>ST</b> = Steel	<b>HSS</b> = High Speed Steel	<b>BR</b> = Brass	<b>ABS</b> = Acrylonitrile Butadiene Styrene
<b>ZAnk</b> = Nickel-plated Zinc Alloy	<b>STzk</b> = Zinc-plated Steel	<b>AL</b> = Aluminium	<b>WD</b> = Wood	<b>EVA</b> = Ethylene Vinyl Acetate

**EP** = **ENGINEERING PLASTIC**

+ **EP** = other engineering plastic available on request

**SR** = **SOFT RUBBER** + **SR** = other soft rubber available on request

<b>EPn</b> = Natural Engineering Plastic	<b>EPc</b> = Clear Engineering Plastic	<b>SRn</b> = Natural Soft Rubber
<b>EPw</b> = White Engineering Plastic	<b>EPg</b> = Grey Engineering Plastic	<b>SRw</b> = White Soft Rubber
<b>EPwg</b> = Water Green Engineering Plastic	<b>EPa</b> = Anthracite Engineering Plastic	<b>SRb</b> = Black Soft Rubber



## FINISHES



+ **OTHER FINISHES AVAILABLE ON REQUEST**

PART NO.	FINISHES	PART NO.	FINISHES	PART NO.	FINISHES
<b>OO</b>	Insignificant finish	<b>IF</b>	Middle Grey	<b>RO</b>	Red
<b>AA</b>	Natural	<b>IJ</b>	Light Grey	<b>UT</b>	T-Met 9007
<b>AB</b>	White	<b>IL</b>	Grey 20	<b>UZ</b>	T-Met
<b>AE</b>	White 9010	<b>IN</b>	Grey met. 26	<b>WA</b>	Bronzed
<b>EA</b>	Black	<b>JB</b>	Bright Aluminium	<b>WI</b>	Burnished
<b>EC</b>	Matt Black	<b>JC</b>	Aluminium - Chrome	<b>XD</b>	Satin-finished Steel
<b>EE</b>	Anthracite	<b>JD</b>	Matt Aluminium	<b>YA</b>	Nickel-plated
<b>EW</b>	Grey 9007	<b>JE</b>	Satin-finished Aluminium	<b>YB</b>	Bright Nickel-plated
<b>FU</b>	Gunmetal	<b>JF</b>	Aluminium - Brass	<b>YC</b>	Matt Nickel-plated
<b>FV</b>	Gunmetal V52	<b>JG</b>	Aluminium 5	<b>YD</b>	Satin-finished Nickel-plated
<b>GR</b>	Raw	<b>JL</b>	Aluminium PE 11	<b>YQ</b>	Black Nickel
<b>HA</b>	Brass-Plated	<b>JM</b>	Aluminium RAL 9006	<b>Z9</b>	Black Zinc
<b>HH</b>	Tropicalized	<b>KA</b>	Chrome	<b>ZA</b>	Zinc alloy
<b>HL</b>	Raw Brass	<b>KB</b>	Bright Chrome	<b>ZN</b>	Zinc-plated
<b>HX</b>	Graphite	<b>KC</b>	Matt Chrome	<b>ZQ</b>	Bright Gold
<b>IA</b>	Grey	<b>LD</b>	Brown 8019	<b>ZY</b>	Titanium
<b>IB</b>	Metallic Grey	<b>NN</b>	Metallic Beige	<b>ZZ</b>	Clear



PK2



PK2 is a wood shelf supports to be slotted into the panel by making face borings. It allows to join together any side and shelf, including bottom and top panels, without using any further connecting fitting. The panel has to be pushed downwards onto the side brackets, which can be screwed into any position required. The side bracket slots into the socket of the shelf supports and a click locks the panel in position. The mini fix within the plastic insert provide a strong structural fastening. By turning the mini fix placed inside the shelf support 90° anticlockwise from the bottom, the shelf and top panel collide with the sides, providing a structural fastening. An optional through hole Ø8 mm allows you to fix also the bottom panel from the top by turning the mini fix 90° anticlockwise.



16 mm min.



Certificates available on request.



INSTALLATION AND ASSEMBLING

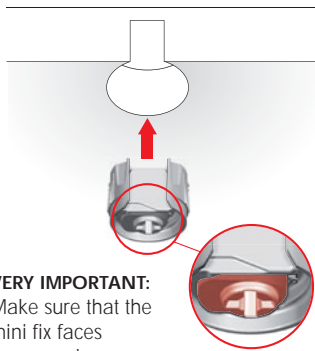

**VERY IMPORTANT:** Make sure that the mini fix faces downwards

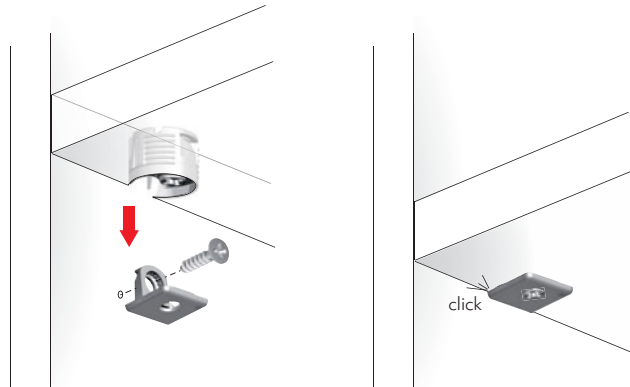

**STRUCTURAL FASTENING WITH CROSS PZ2 SCREWDRIVER:**

90° turning from the upper side, for the furniture floor.

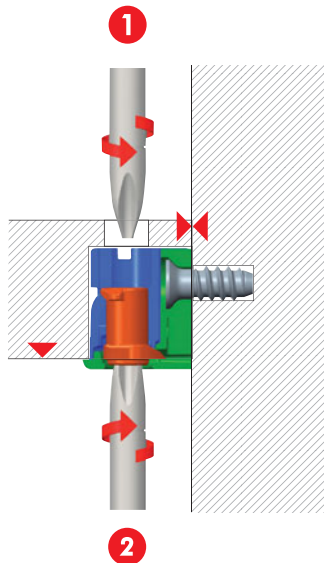
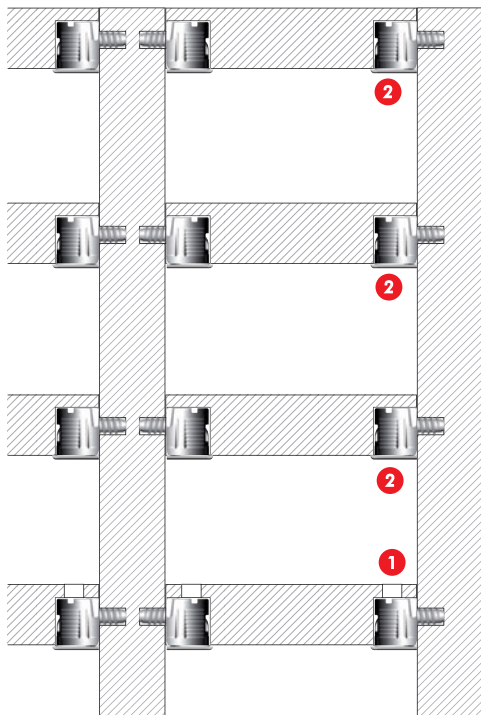

90° turning from the lower side, for the shelves and for the top.

Assembling with alternative fixing options.

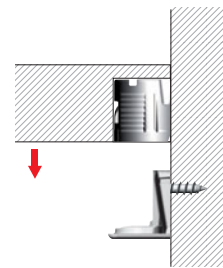

Assembling with pre-inserted spreading bush and screw to avoid hole damaging for shelf repositioning.

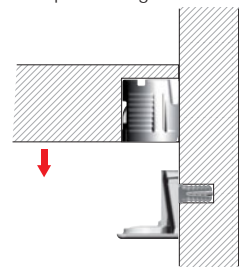

**LOCKING DETAIL:**

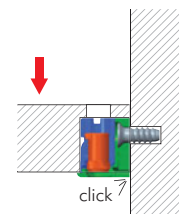

After turning the minifix.

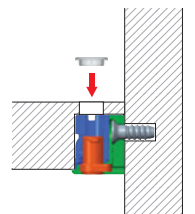



**PK2 TEMPLATE**

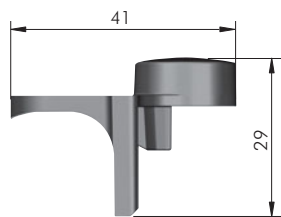
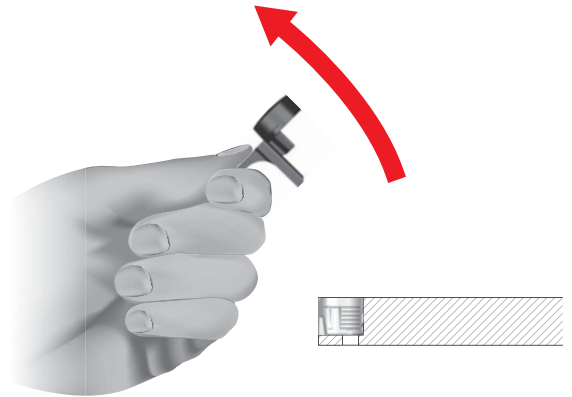
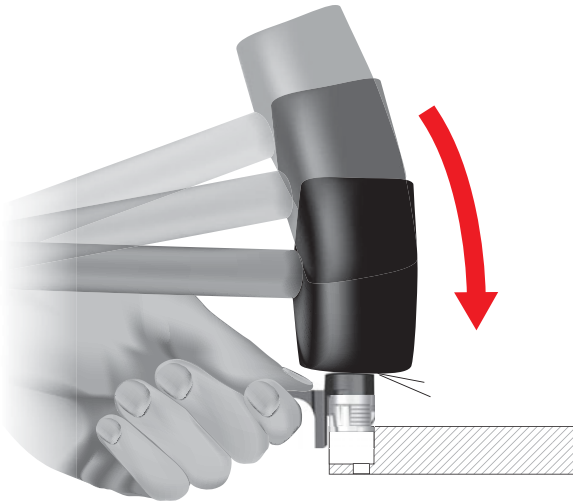
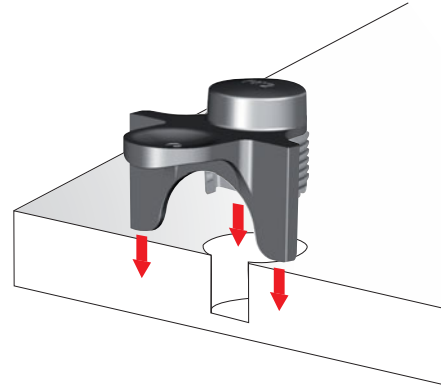

EPb	= on request
1145001000	



PK2  16 mm

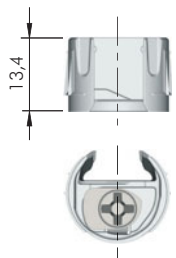
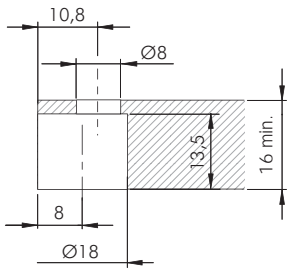

 = PZ2

ZA EP

 = 2500 pcs.



11401010IJ

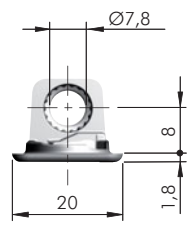
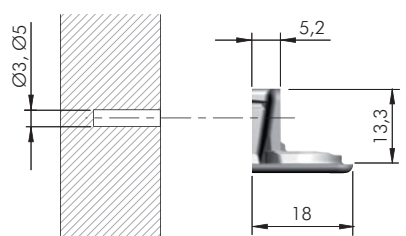

 = Ø 3, Ø 5 mm

+ 

ZA

 = 2500 pcs.



11402010YA

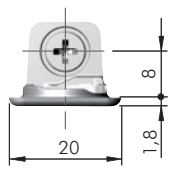
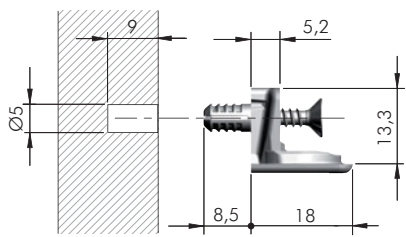

 = Ø 5 mm

+ 

 = PZ2

ZA ST EP

 = 2500 pcs.



11402020YA

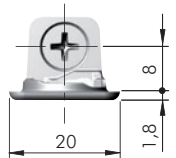
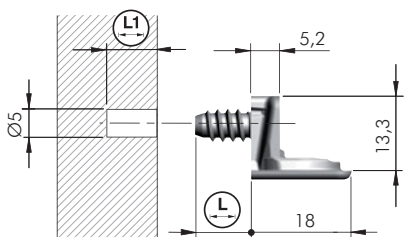

 = Ø 5 mm

+ 

 = PZ2

ZA ST

 = 2500 pcs.



11402090YA



8,8



9,5

11402030YA

10

10,5

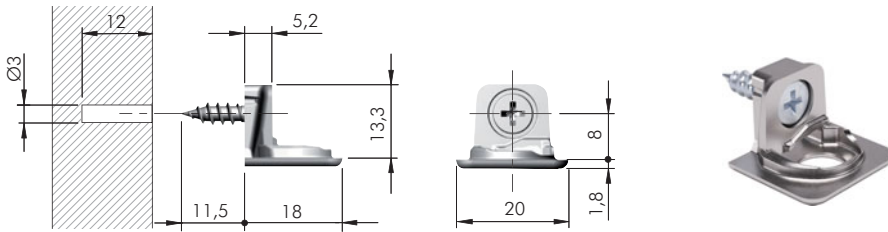

= Ø 3 mm	
= PZ2	
ZA ST	= 2500 pcs.
1142050YA	

**DRILL BIT FOR PK2** **16 mm**

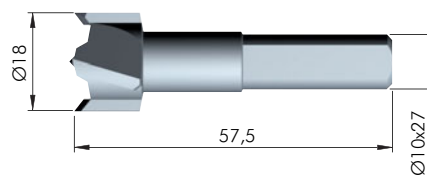
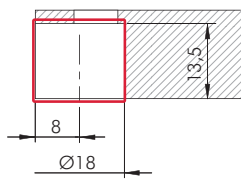

HSS	= on request
1145201000	

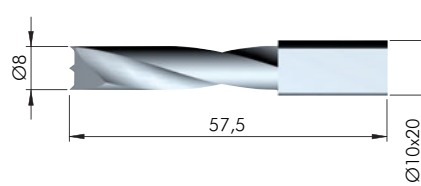
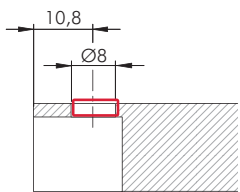

HSS	= on request
1145202000	

**PK2** **18 - 19 mm**

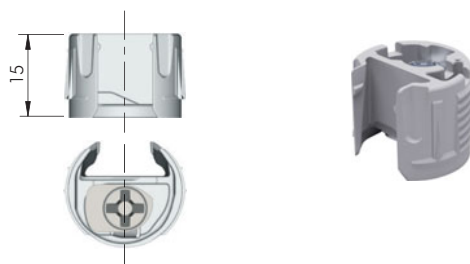
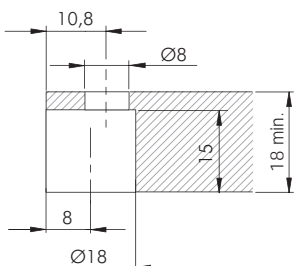

= PZ2	
ZA EP	= 2500 pcs.
11401030IJ	

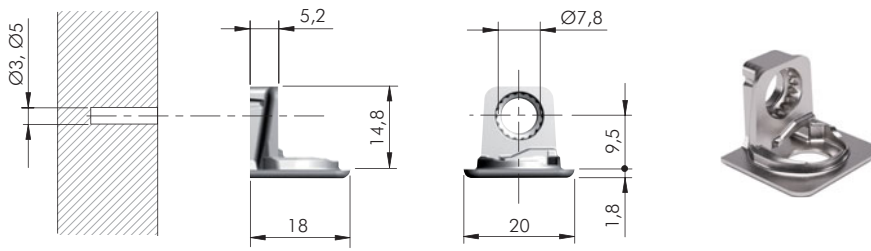

= Ø 3, Ø 5 mm +   
 = 2500 pcs.  
  
**11403010YA**

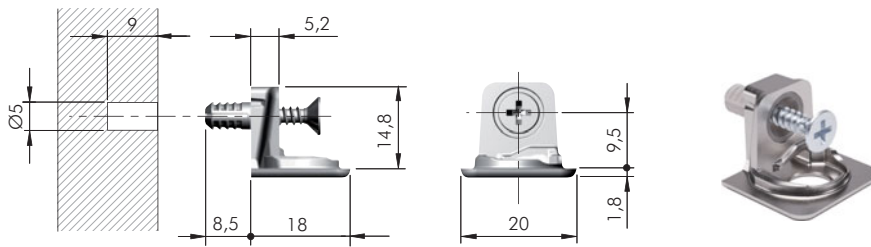

= Ø 5 mm +   
 = PZ2  
 = 2500 pcs.  
  
**11403020YA**

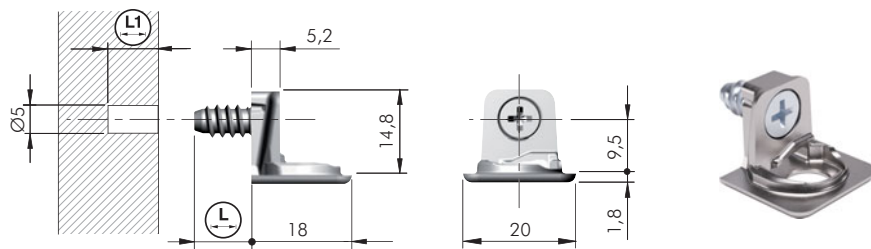

= Ø 5 mm +   
 = PZ2  
 = 2500 pcs.  
  
**11403100YA**    8,8    9,5  
**11403030YA**    10    10,5

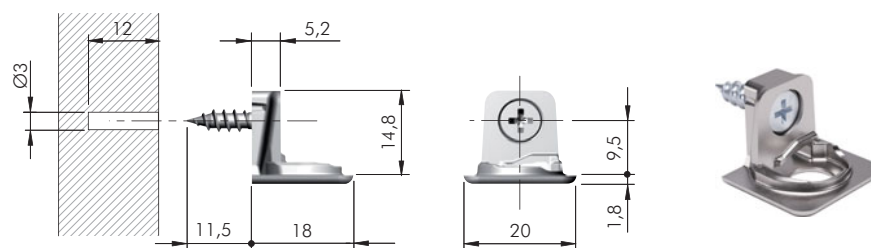



= Ø 3 mm +   
 = PZ2  
 = 2500 pcs.  
  
**11403050YA**





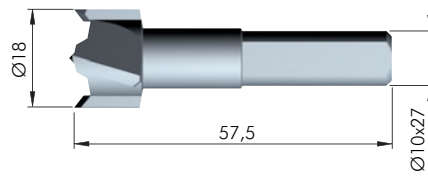
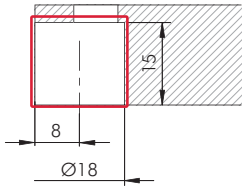

DRILL BIT FOR PK2  18 - 19 mm





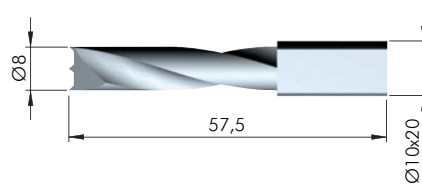
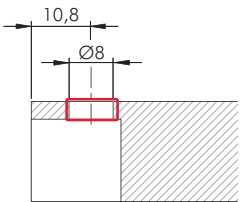

HSS  = on request

  | 

**1145201000**





HSS  = on request

  | 

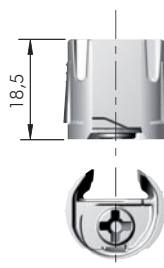
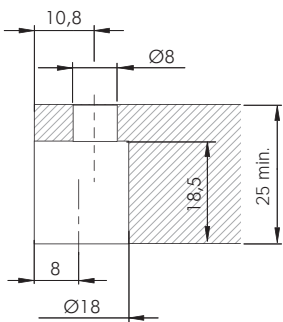

**1145202000**

PK2  25 mm







 = PZ2

ZA EP  = 2000 pcs.

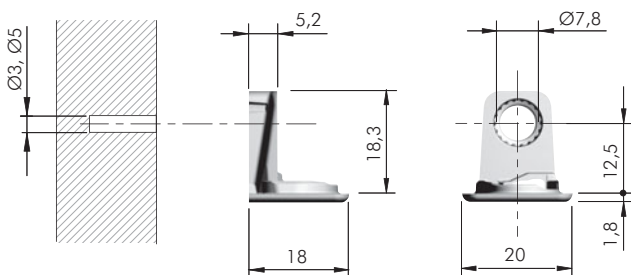

  | 

**11401050IJ**



 = Ø 3, Ø 5 mm  

ZA  = 2000 pcs.

  | 

**11404010YA**

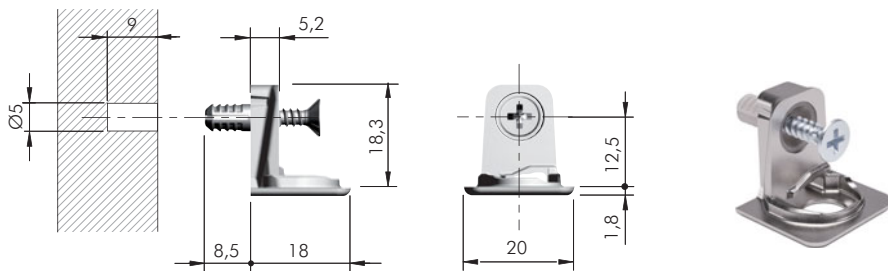

= Ø 5 mm +

= PZ2

ZA ST EP  = 2000 pcs.



11404020YA

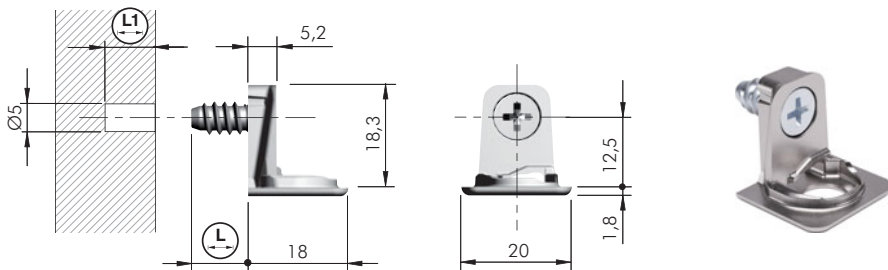

= Ø 5 mm +

= PZ2

ZA ST  = 2000 pcs.



11404100YA



8,8



9,5

11404030YA

10

10,5

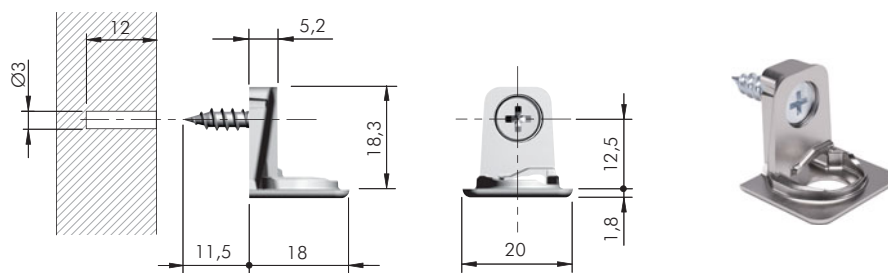

= Ø 3 mm +

= PZ2

ZA ST  = 2000 pcs.



11404050YA

DRILL BIT FOR PK2 25 mm

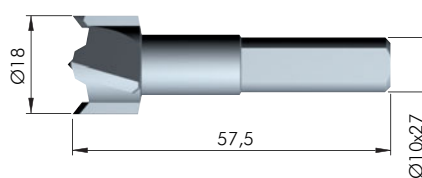
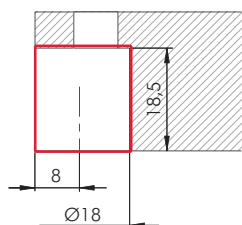

ST  = on request

1145201000

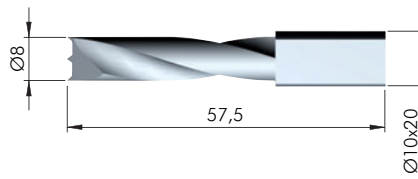
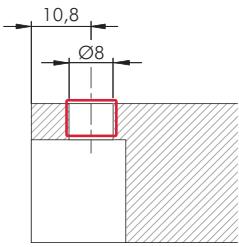

ST	= on request
123	
<b>1145202000</b>	<b>R</b>

**PK2** **29 mm**

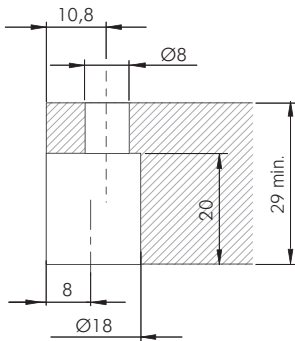

= PZ2	= 2000 pcs.
ZA EP	
123	
<b>11401070IJ</b>	

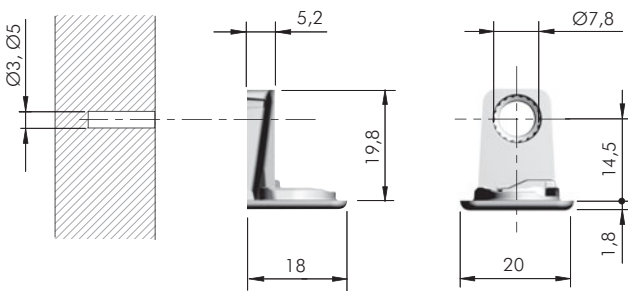

= Ø 3, Ø 5 mm	
ZA	= 2000 pcs.
123	
<b>11405010YA</b>	

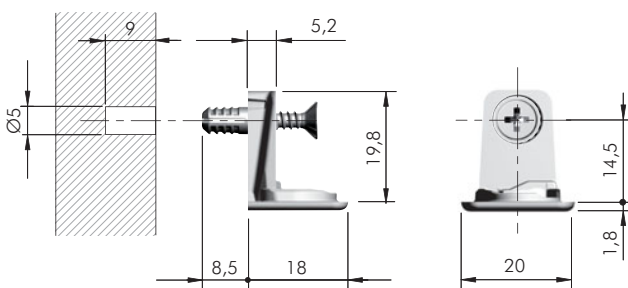

= Ø 5 mm	
= PZ2	= 2000 pcs.
ZA ST EP	
123	
<b>11405020YA</b>	

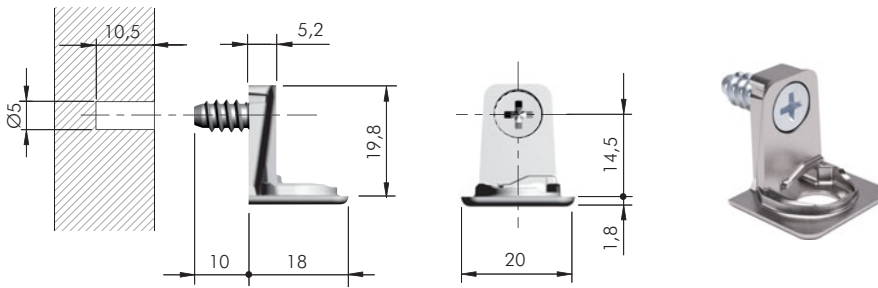

= Ø 5 mm +   
 = PZ2  
 = 2000 pcs.  
  
**11405030YA**

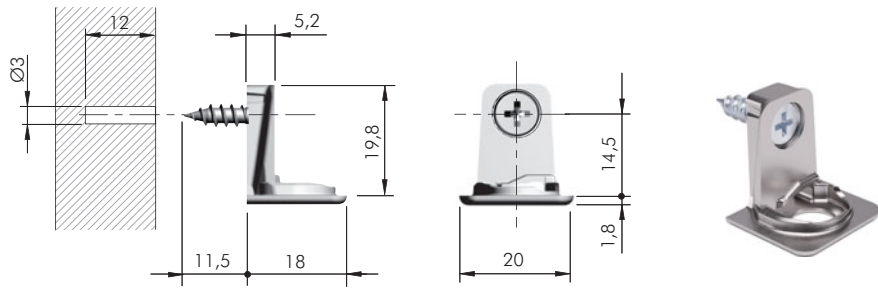

= Ø 3 mm +   
 = PZ2  
 = 2000 pcs.  
  
**11405050YA**

DRILL BIT FOR PK2 29 mm

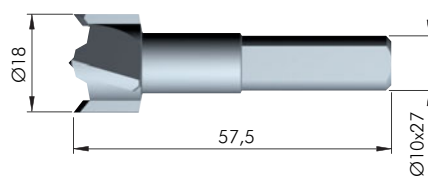
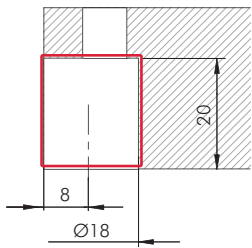

= on request  
  
**1145201000**

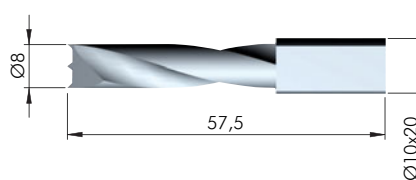
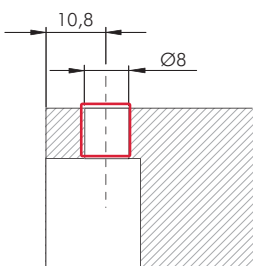

= on request  
  
**1145202000**



**PK2 ACCESSORY**

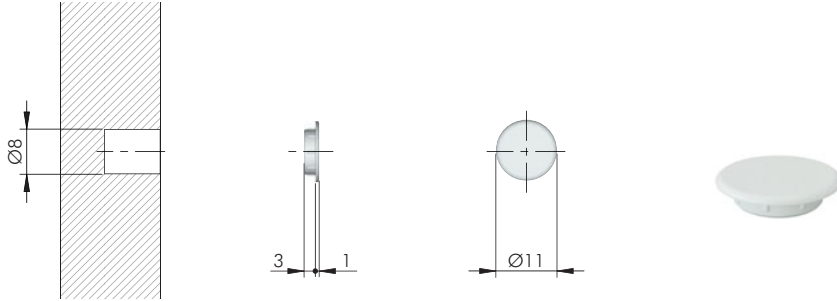

= Ø 8 mm      +

     = 5000 pcs.

123

**23002010AB**

**PK2 FIXING ACCESSORIES**



= Ø 3 mm

= PZ2

     = 5000 pcs.

123

**60101570ZN**

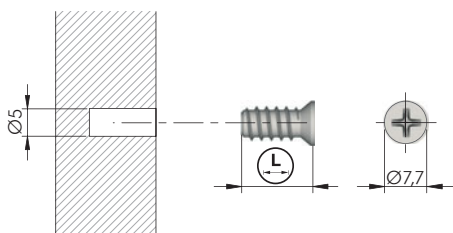

= Ø 5 mm      +

= PZ2

     = 5000 pcs.

123	
<b>60502010ZN</b>	10
<b>60501050YA</b>	12,7
<b>60502020ZN</b>	13
<b>60502030ZN</b>	15

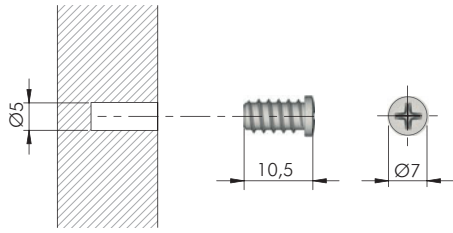

= Ø 5 mm +   
 = PZ2  
 = 5000 pcs.

123   
**60507010YA**

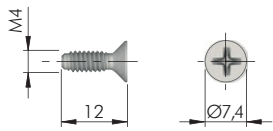

= M4 = PZ2  
 = on request

123   
**60305040ZN**

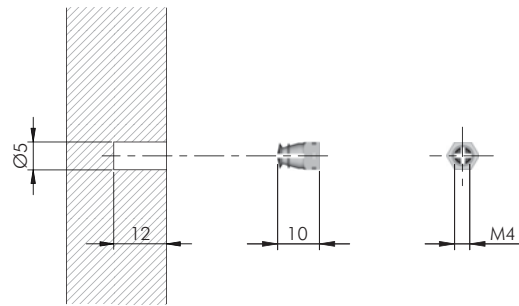

= Ø 5 mm = M4  
 = 10.000 pcs.

123   
**20502021HL**

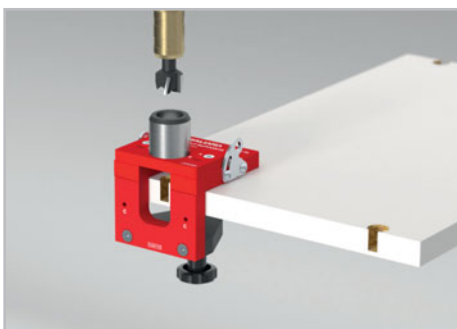

All the information about drilling jigs are available at the end of the chapter "Shelf Supports".



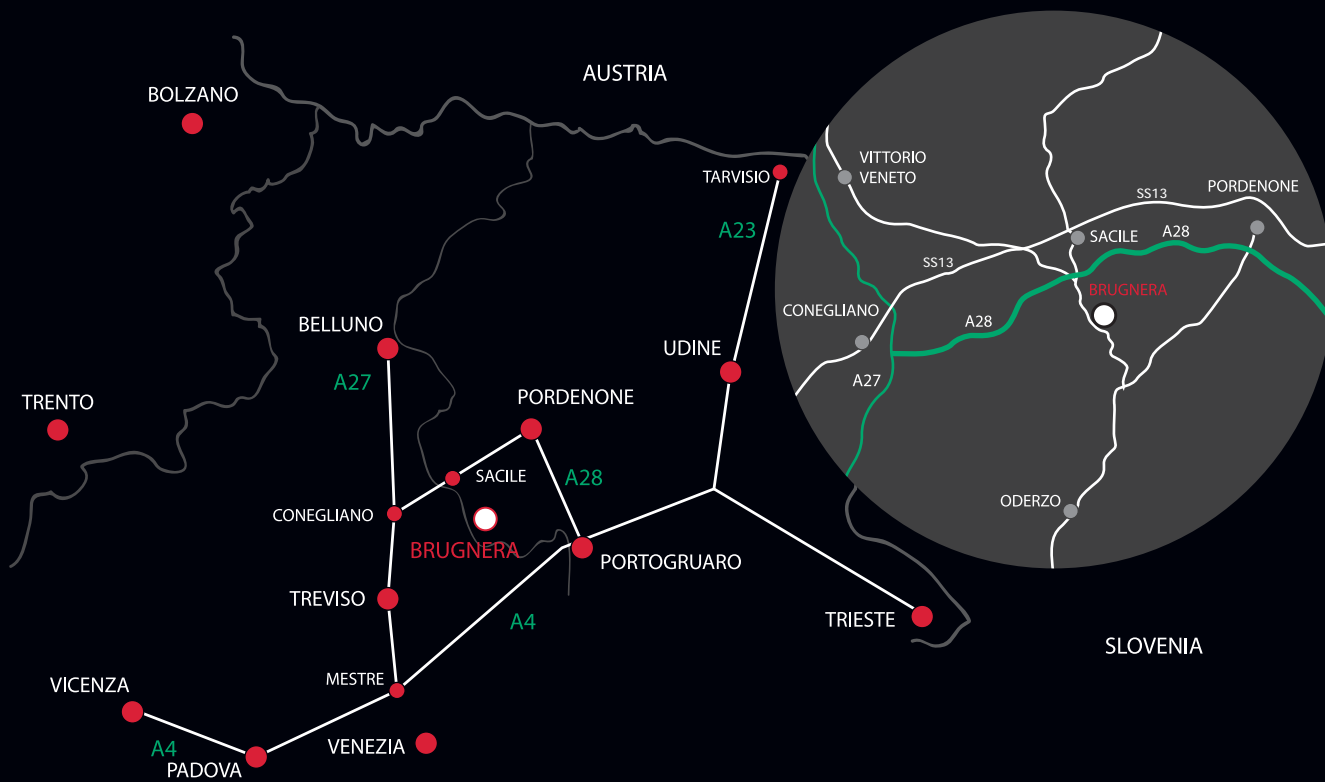

[www.italianaferramenta.it](http://www.italianaferramenta.it)