

LIFTING
SYSTEMS

SE Series
TOP-STAYS

TOP-STAYS

The new experience of the lift-up door

Agile and Unconstrained, Easy and Convenient



- Easy to open and stays at any desired position, silent and smooth closing
- Easy installation, simple, effective and precise adjustment





TOP-STAYS SE is a program of compact lifting hardware that provides soft-close, push-open, and dynamic features that lifts doors smoothly and holds them at any desired position. They are an ideal solution for smaller wall cabinets.

DTC
DYNAMIC TOP CLOSURES

LIFTING SYSTEMS TOP-STAYS



The sleek and compact design offers optional cover caps in nickel, white, black or gray to blend with or complement cabinet interiors for a pleasing visual aesthetic.

PRODUCT



DESCRIPTION

- Opening angle: 105°
- Cabinet width up to 1800mm
- Cabinet height: 240-600mm
- Cabinet minimum depth: 125mm
- Door thickness: 16-26mm
- Easy to open and stays at any desired position
- Silent and smooth closing
- Side, height and depth adjustment
- Tool free assembly and removal

Power factor LF=

Cabinet height KH(mm) x door weight incl. double handle weight(kg)

Note: A practical trial is suggested when the power factor of lift mechanism is close to the critical value.

ORDER INFORMATION

	Lift Mechanism set/ Industrial Package Nickel Plated(A01)			
	Power Factor LF	Dynamic	Item No.	Set/ctn
	200-1000	Light	SE00AL	20
	500-1500	Medium	SE00AM	20
960-2350	Strong	SE00AH	20	
The power factor can be double when a second lift mechanism is used.				
	Front Fixing-brackets/ Industrial Package for wooden door and wide Alu frame door Nickel Plated(A01)			
	Item No.	SE00YQ		
	Pcs/ctn	200		
	Front Fixing-brackets/Industrial Package for wooden door, wide Alu frame door and narrow frame door Nickel Plated(A01)			
	Item No.	SE00CQ		
	Pcs/ctn	200		
	Front Fixing-brackets set/Industrial Package for narrow alu frame door Nickel Plated(A01)			
	Item No.	SE00H		
	Set/ctn	200		
4 pcs Φ3.5X8.5mm countersunk screws included				
	Mounting plate/Industrial Package Nickel Plated(A01)			
	Item No.	SE00TQ		
	Pcs/ctn	200		
	Caps/Industrial Package White(H29) Grey(H30) Nickel Plated(A01)			
		Item No.	Set/ctn	
	Left	SEJ502L	200	
Right	SEJ502R	200		

	Soft-close hinge for wooden door and wide Alu frame door/ Industrial Package Nickel Plated(A01)			
	Item No.	C80A676F		
	Pcs/ctn	200		
3 hinges are required when the cabinet width is over 900mm or the power factor is over 1800 4 hinges are required when the cabinet width is over 1200mm or the power factor is over 2700				
Alternative PIVOT-STAR speed-adjustable hinge C81A676F. Door thickness:16-26mm.				
	Soft-close hinge for narrow Alu frame door / Industrial Package Nickel Plated(A01)			
	Item No.	C80A678F		
	Pcs/ctn	200		
3 hinges are required when the cabinet width is over 900mm or the power factor is over 1800 4 hinges are required when the cabinet width is over 1200mm or the power factor is over 2700 Range of width of aluminium frame(V):19-22mm.				
	Adjustable mounting plate/Industrial Package Nickel Plated(A01)			
	Item No.	89T00TQ		
	Pcs/ctn	200		
Use mounting plate 81T00TQ for PIVOT-STAR speed adjustable hinge C81A676F				

ORDER INFORMATION

T1 Recommended Kit Package

Including:

1 X Lift Mechanism	1 X Front Fixing-bracket	1 X Mounting plate	4 X wooden screws Ø4X16mm

Please select the corresponding kit package item No. according to power factor and cabinet height

Power Factor(LF)	Cabinet Height	Kit package item No.
200-1000	240-600mm	SE00AL01
500-1500		SE00AM01
960-2350		SE00AH01

Spring holder colours represent different powers
Light grey
Dark grey
White



! Front fixing bracket SE00H should be ordered when the front is narrow Alu frame door.

PRODUCT



DESCRIPTION

- Opening angle: 105°
- Cabinet width up to 1800mm
- Cabinet height: 240-600mm
- Cabinet minimum depth: 125mm
- Door thickness: 16-26mm
- Handle-less, stays at any desired position
- Silent and smooth closing
- Side, height and depth adjustment
- Tool free assembly and removal

Power factor LF=

Cabinet height KH(mm) x door weight incl. double handle weight(kg)

Note: A practical trial is suggested when the power factor of lift mechanism is close to the critical value.

ORDER INFORMATION

1		Lift Mechanism set/ Industrial Package Nickel Plated(A01)			
		Power Factor LF	Dynamic	Item No.	Set/ctn
		200-1000	Light	SE2FAL	20
		500-1400	Medium	SE2FAM	20
		960-2050	Strong	SE2FAH	20
The power factor can be double when a second lift mechanism is used.					
2		Front Fixing-brackets/ Industrial Package for wooden door and wide Alu frame door Nickel Plated(A01)			
		Item No.	SE00YQ		
		Pos/ctn 200			
2		Front Fixing-brackets/Industrial Package for wooden door, wide Alu frame door and narrow frame door Nickel Plated(A01)			
		Item No.	SE00CQ		
		Pos/ctn 200			
2		Front Fixing-brackets set/Industrial Package for narrow alu frame door Nickel Plated(A01)			
		Item No.	SE00H		
		Set/ctn	200		
		4 pcs Φ3.5X8.5mm countersunk screws included			
3		Mounting plate/Industrial Package Nickel Plated(A01)			
		Item No.	SE00TQ		
		Pos/ctn 200			
		Caps/Industrial Package White(H29) Grey(H30) Nickel Plated(A01)			
			Item No.	Set/ctn	
		Left	SEJS02L	200	
	Right	SEJS02R	200		

4		Unsprung hinge for wooden door and wide Alu frame door/ Industrial Package Nickel Plated(A01)			
		Item No.	A80A675		
		Pos/ctn 200			
3 hinges are required when the cabinet width is over 900mm or the power factor is over 1800					
4 hinges are required when the cabinet width is over 1200mm or the power factor is over 2700					
Door thickness: 16-26mm					
4		Unsprung hinge for narrow Alu frame door / Industrial Package Nickel Plated(A01)			
		Item No.	A80A67B		
		Pos/ctn 200			
3 hinges are required when the cabinet width is over 900mm or the power factor is over 1800					
4 hinges are required when the cabinet width is over 1200mm or the power factor is over 2700					
Range of width of aluminum frame(V): 19-22mm					
5		Mounting plate/Industrial Package Nickel Plated(A01)			
		Item No.	89H00AQ		
		Pos/ctn 200			
6		Insert-type Magnetic Push Latch/Industrial Package			
		Item No.	M5-A011A		
		Pos/ctn 200			

Alternative: Push Latch see page 200

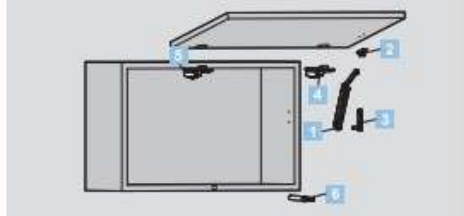

ORDER INFORMATION

T1 Recommended Kit Package

Including:



Please select the corresponding kit package item No. according to power factor and cabinet height

Power Factor(LF)	Cabinet Height	Kit package item No.
200-1000	240-600mm	SE2FAL01
500-1400		SE2FAM01
960-2050		SE2FAH01

Spring holder colours represent different powers

Light grey
Dark grey
White



T2 Recommended Kit Package

Including:



Please select the corresponding kit package item No. according to power factor and cabinet height

Power Factor(LF)	Cabinet Height	Kit package item No.
200-1000	240-600mm	SE2FAL01A
500-1400		SE2FAM01A
960-2050		SE2FAH01A

Spring holder colours represent different powers

Light grey
Dark grey
White



1 Front fixing bracket SE00H should be ordered when the front is narrow Alu frame door.

TOP-STAYS

SE Series Push-open Lifting System

TOP-STAYS

Assembly, Removal and Adjustment(for SE Series Lifting System)

PLANNING

Installation Dimensions(mm)

Peg position and space requirement

Space requirement

SOB Top panel thickness

B Hinge mounting plate height

B	0mm	2mm	4mm	9mm	18mm
Mounting plate	H=0	H=2	H=4	H=9	H=18

C Hinge overlay



* Minimum 200mm for suspension bracket application

$$Y = (FH - a) \times 0.3$$

FH=Front height

FD (mm)	16	19	22	24
a (mm)	45	34	23	15

Door Assembly - wooden doors and wide alu frames

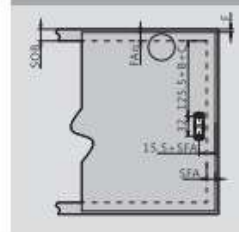

Door Assembly - narrow alu frames

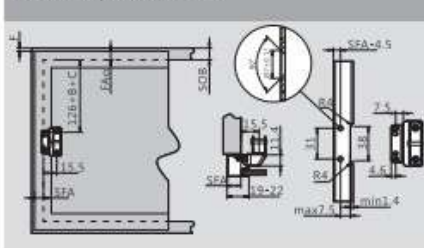

Door Assembly - wooden doors/ wide alu frames/ narrow alu frames

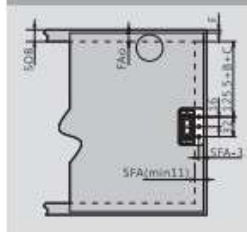

Cornice/crown moulding clearance

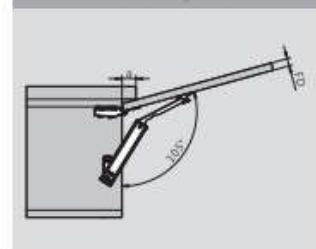

FD (mm)	16	19	22	24
a (mm)	45	34	23	15

Minimum gap

MFu=1.5mm

K(mm)	3	4	5	6	Mounting plate
D(mm)	15	16	17	18	H=0
	13	14	15	16	H=2
	11	12	13	14	H=4
	8	7	8	9	H=9

K=Drilling distance D=Required door overlay

FD=	16	17	18	19	20	21	22	23	24	25	26
K=0 MFo=	0.7	0.9	1.2	1.5	1.8	2.2	2.6	3.2	3.8	4.5	5.3
K=4 MFo=	0.7	0.9	1.1	1.4	1.6	2.1	2.5	3.0	3.5	4.4	4.9
K=8 MFo=	0.8	0.9	1.1	1.4	1.7	2.0	2.4	2.9	3.4	3.8	4.6
K=6 MFo=	0.8	0.8	1.1	1.3	1.6	2.0	2.4	2.8	3.2	3.8	4.4

F: Gap

FAo: Top panel overlay

MFu: Bottom Min. gap

MFo: Top Min. gap

SFA: Side panel overlay= side thickness - gap

FD: Door thickness

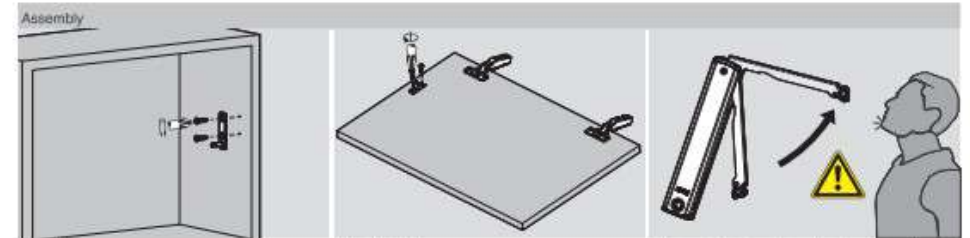

Assembly

Door Assembly

The arm of this device could spring up and cause injury. Do not push the arm down without door attached.



Door Assembly

Hoisting Adjustment

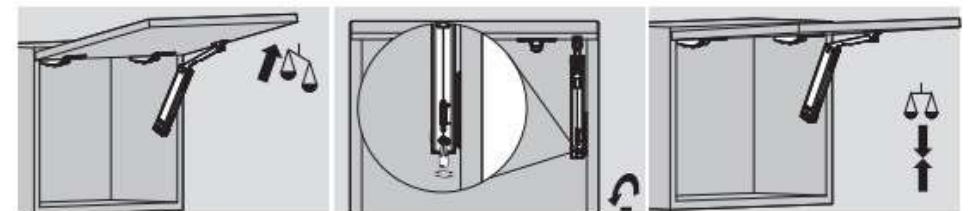
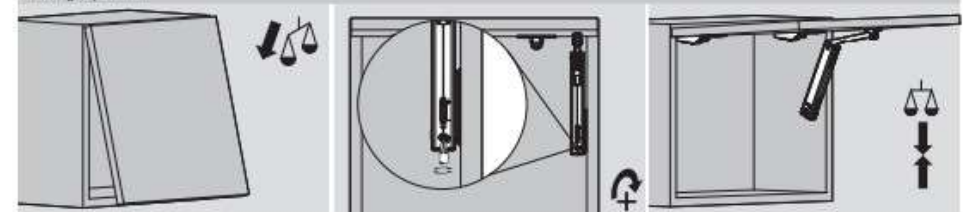

TOP-STAYS

Assembly , Removal and Adjustment (for SE Series Lifting System)

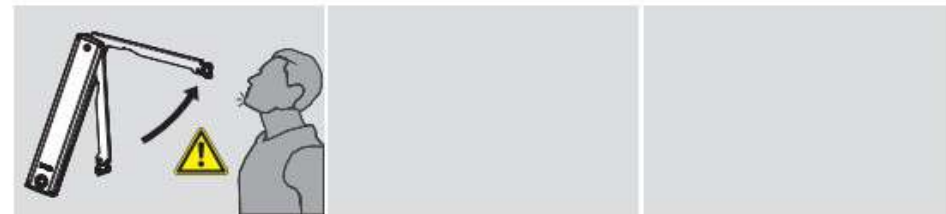
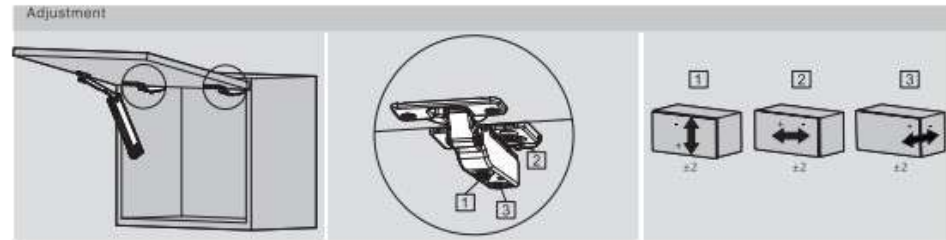

The arm of this device could spring up and cause injury!

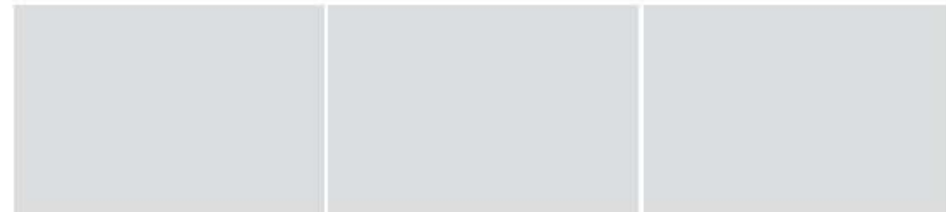

TOP-STAYS

Assembly (for SE Series Push-open Lifting System)

PLANNING

