

LIFTING
SYSTEM

SF Series

TOP-STAYS



The new experience of the lift-up door

Agile and Unconstrained,
Enjoy Quality Life



- Closing speed adjustable, easy to open and stays at any desired position, silent and smooth closing
- Snap-fit mechanism makes installation and dismantling very easy
- High stability, wide application, provide ideal opening and shutting effects for door panels with various dimensions and made of various materials.



Quietness



Intelligence



Durability



Eco-Friendliness



The TOP-STAYS SF series is suited for wider wall cabinets that have heavier fronts. They open easily and give unrestricted access to the entire contents of the cabinet.

DTC
Durable Technology Cabinet

LIFTING SYSTEMS
TOP-STAYS



TOP-STAYS SF is a stable lifting system for a wide range of cabinet applications and provides perfect opening and closing action for fronts of various dimensions or materials.

PRODUCT



DESCRIPTION

- Opening angle: 107° / 100°
- Cabinet width up to 1800mm
- Cabinet height: 250-700mm
- Door thickness: 16-28mm
- 3D door adjustments:
Height adjustment: +/- 2mm,
Depth adjustment: +/- 2mm,
Side adjustment: +/- 2mm,
- Easy to open, and stays at any desired position
- Adjustable soft-closing speed
- Adjustable opening and hovering forces
- Tool free assembly and removal
- Single and dual-colour caps at your disposal

Power factor LF=

Cabinet height (KH) x door weight
Incl. double handle weight (kg)

Note: The power factor LF and the door weight can be increased by 50% when a third lift mechanism is used.

ORDER INFORMATION

1	Lift Mechanism set/ Industrial Package			
Power Factor LF Dynamic	Opening angle	Item No.	Set/ctn	
480-1500	Extra Light	107°	SF00AD	10
750-2500	Light	107°	SF00AL	10
1500-4900	Medium	107°	SF00AM	10
3200-9000	Strong	107°	SF00AH	10

2	Opening angle restriction clip / Industrial Package		
100°	Dark grey(H11)		
75°	Opening angle	Item No.	Pos/ctn
	100°	SFW100	1000
	75°	SFW75	1000

3	Front Fixing-brackets set/Industrial Package For Wooden Door and Wide Alu Frames
Nickel Plated	
Item No.	SF00YQ
Set/ctn	200

4	Narrow Alu Frame fixing-brackets set Industrial Package For Narrow Alu Frames
Nickel Plated(A01)	
Item No.	SF00H
Set/ctn	100
16 pcs	3.5X8.5mm countersunk screws included

5	Single Caps(left/right) / Industrial Package	
Colour	Item No.	Set/ctn
White	SFJS02A	20
Grey	SFJS02B	20

6	Dual-colour Caps(left/right) / Industrial Package	
Colour	Item No.	Set/ctn
White+ light grey	SFJS01A	20
Grey+ dark grey	SFJS01B	20
White+ nickel plated	SFJS01C	20
Grey+ nickel plated	SFJS01D	20

7	Decoration cover for hinge arm /Industrial Package Nickel Plated(A01)
Item No.	S16H
Set/ctn	4000

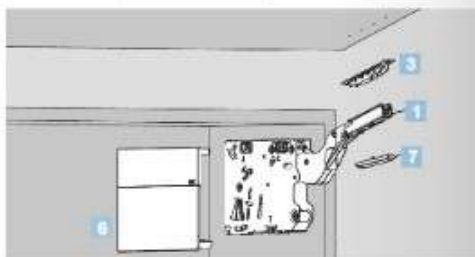
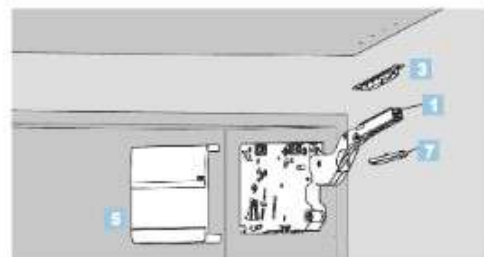

ORDER INFORMATION

T1 Recommended Kit Package

Including:

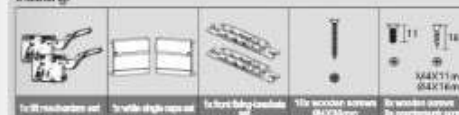

Please select the corresponding kit package item No. according to power factor and cabinet height

Power Factor(LF)	Cabinet Height	Kit package item No.
480-1500	250-500mm	SF00AD02A
750-2500	250-500mm	SF00AL02A
1500-4900	350-500mm	SF00AM02A
3200-9000	400-700mm	SF00AH02A

T2 Recommended Kit Package

Including:

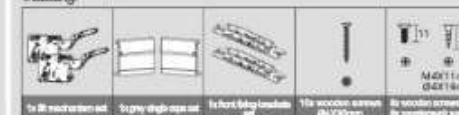

Please select the corresponding kit package item No. according to power factor and cabinet height

Power Factor(LF)	Cabinet Height	Kit package item No.
480-1500	250-500mm	SF00AD02B
750-2500	250-500mm	SF00AL02B
1500-4900	350-500mm	SF00AM02B
3200-9000	400-700mm	SF00AH02B

T3 Recommended Kit Package

Including:



Please select the corresponding kit package item No. according to power factor and cabinet height

Power Factor(LF)	Cabinet Height	Kit package item No.
480-1500	250-500mm	SF00AD03A
750-2500	250-500mm	SF00AL03A
1500-4900	350-500mm	SF00AM03A
3200-9000	400-700mm	SF00AH03A

T4 Recommended Kit Package

Including:

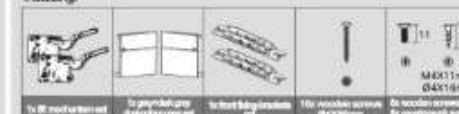

Please select the corresponding kit package item No. according to power factor and cabinet height

Power Factor(LF)	Cabinet Height	Kit package item No.
480-1500	250-500mm	SF00AD03B
750-2500	250-500mm	SF00AL03B
1500-4900	350-500mm	SF00AM03B
3200-9000	400-700mm	SF00AH03B

T5 Recommended Kit Package

Including:

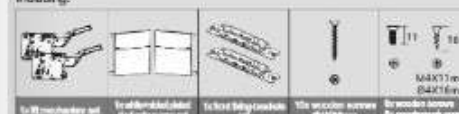

Please select the corresponding kit package item No. according to power factor and cabinet height

Power Factor(LF)	Cabinet Height	Kit package item No.
480-1500	250-500mm	SF00AD01C
750-2500	250-500mm	SF00AL01C
1500-4900	350-500mm	SF00AM01C
3200-9000	400-700mm	SF00AH01C

T6 Recommended Kit Package

Including:



Please select the corresponding kit package item No. according to power factor and cabinet height

Power Factor(LF)	Cabinet Height	Kit package item No.
480-1500	250-500mm	SF00AD01D
750-2500	250-500mm	SF00AL01D
1500-4900	350-500mm	SF00AM01D
3200-9000	400-700mm	SF00AH01D

In the case of narrow alu frame application, order fixing-brackets SF00H separately.

TOP-STAYS

SF Series Lifting System

PLANNING

Installation Dimensions(mm)

Peg position and space requirement

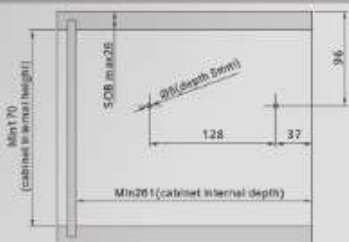

SOB: top panel thickness

Fixing Position

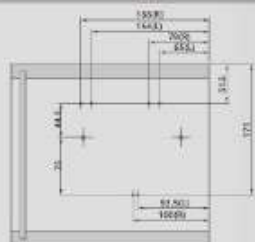

3x wooden screws: Ø4X32mm

Door planning and assembly- wooden doors and wide alu frames



8 wooden screws for wooden doors (Ø4X16mm)
6 countersunk screws for wide alu frames (MAX11mm)
SFA: door overlay on the side panel
F: gap

Door planning and assembly- narrow alu frames

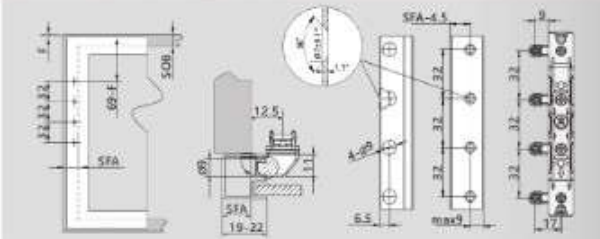

16 countersunk screws for narrow alu frames (Ø3.5X8.5mm)

*When changing material thickness, adjust the assembly dimensions accordingly

Cornice/crown moulding clearance

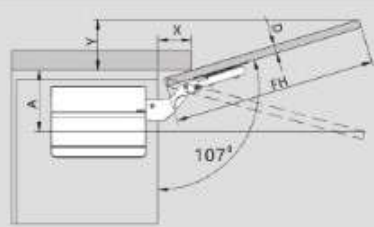

D(mm)	16	19	22	26	28
X(mm)	70	58	49	35	26
Opening angle restriction		Space requirement (mm)			
without		$Y = FH \times 0.28 - 15 + D$			
100°		$Y = FH \times 0.17 - 15 + D$			
75°		$A = FH \times 0.28 + 15 - D$			

Minimum gap

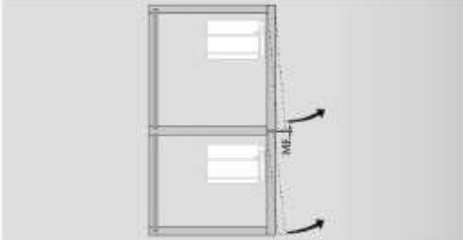

MF: Minimum gap 2mm

TOP-STAYS

Assembly, Removal and Adjustment(for SF series Lifting System)

Assembly

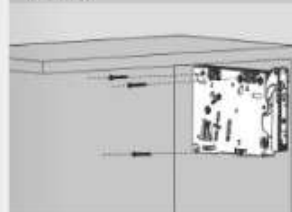

Assembly

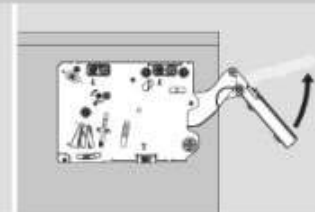

Caution when opening arm

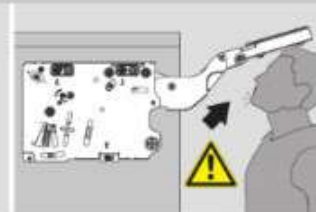

The arm of this device could spring up and cause injury. Do not push the arm down without door attached.

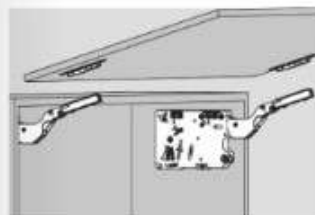

Door Assembly

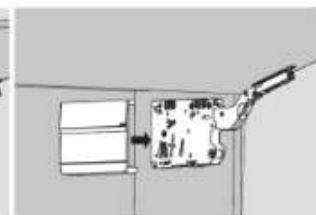
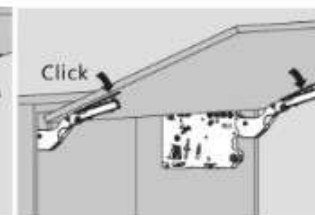

Hovering Adjustment

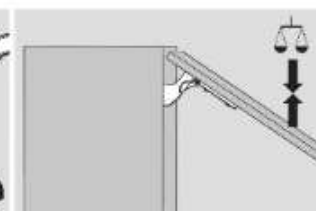
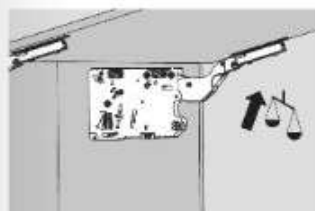

TOP-STAYS

Assembly, Removal and Adjustment (for SF series Lifting System)



Closing Speed Adjustment

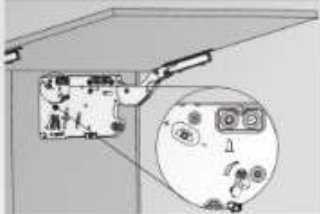

- * Increasing soft-closing time (turn adjustment screw counter-clockwise)
- ** reducing soft-closing time (turn adjustment screw clockwise)

Door Position Adjustment

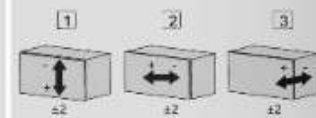
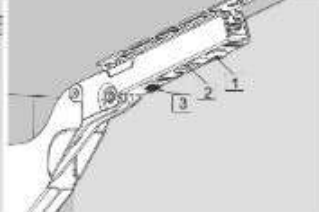
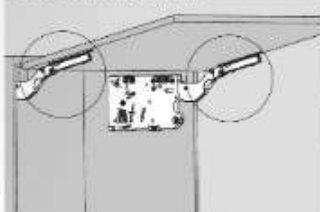

Removal

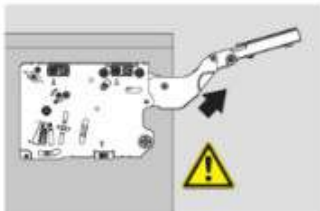
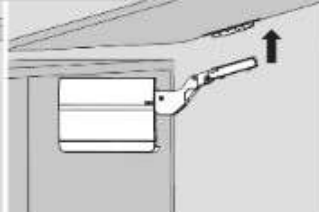
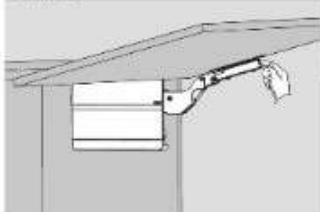

The arm of this device could spring up and cause injury!



Do not push the arm down without door attached

Opening angle restriction clip

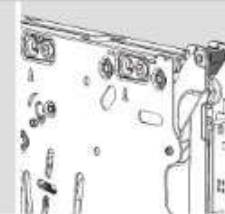
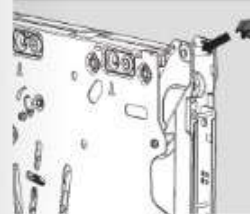

Assembly

