

EPOXY SLIDES

A Series Bottom Mounted Epoxy Roller Slides



PRODUCT



DESCRIPTION

- Load capacity: 25kg
- Self-closing
- Double stop positions
- Lengths: 250-600mm
- Silent wheels
- Finish: white(E01)/grey(E03)/brown(E04)/black(E05)

SPACE REQUIREMENT

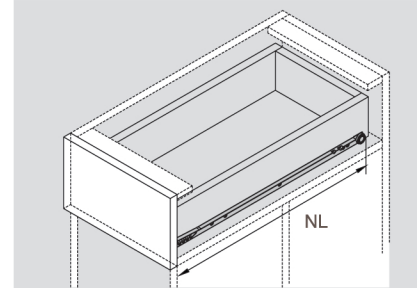

NL Nominal length

ORDER INFORMATION

1 Slides (left/right)				
White(E01) Grey(E03) Brown(E04) Black(E05)				
NL	Thickness 1.0mm item No.	Thickness 1.2mm item No.	Set/ctn	
250mm	A109	A101	24	
300mm	A129	A121	24	
350mm	A149	A141	24	
400mm	A169	A161	24	
450mm	A189	A181	24	
500mm	A209	A201	24	
550mm	A229	A221	24	
600mm	A249	A241	24	

Installation Dimensions(mm)

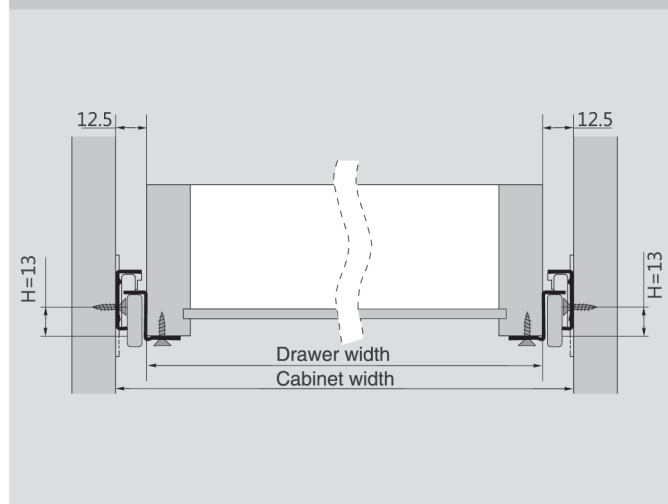

Screw Positions of the Slides(mm)

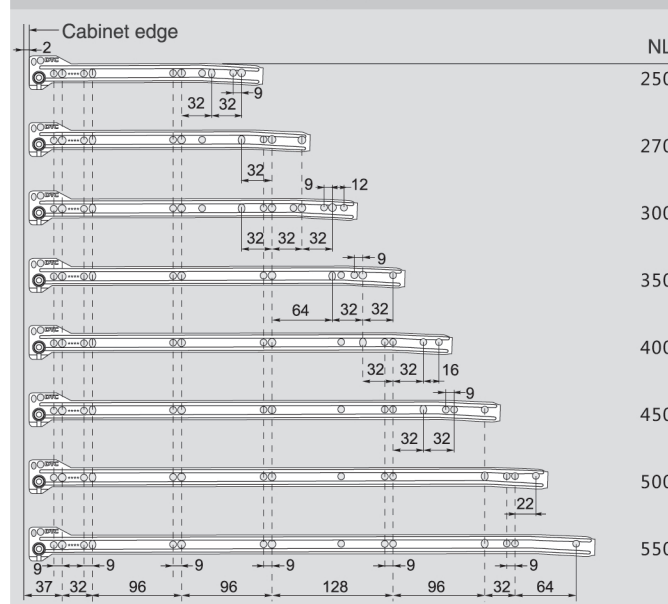

Drawer

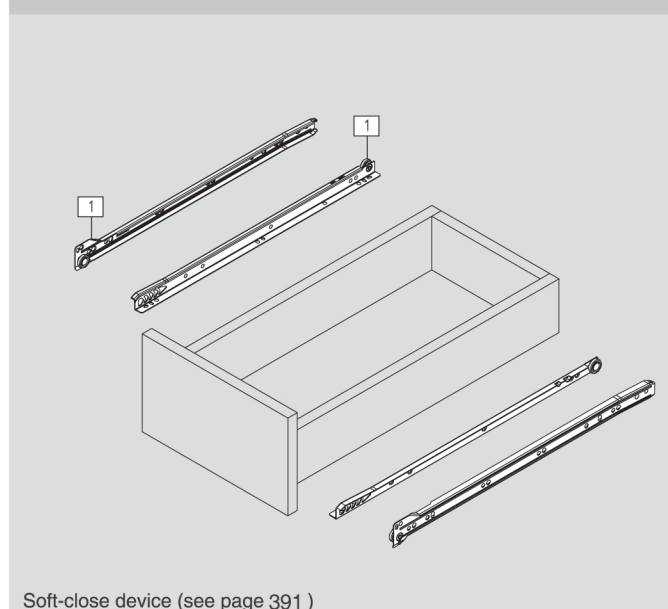

EPOXY SLIDES

L Series Bottom Mounted Epoxy Roller Slides



PRODUCT



DESCRIPTION

- Load capacity: 25kg
- Self-closing
- Double stop positions
- Lengths: 250-600mm
- Silent wheels
- Finish: white(E01)/grey(E03)/brown(E04)/black(E05)

SPACE REQUIREMENT

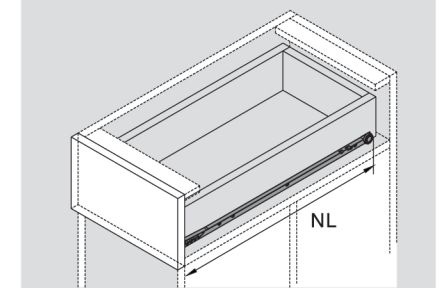

NL Nominal length

ORDER INFORMATION

1 Slides (left/right)				
White(E01) Grey(E03) Brown(E04) Black(E05)				
NL	Thickness 1.0mm item No.	Thickness 1.2mm item No.	Set/ctn	
250mm	L109	L101	24	
300mm	L129	L121	24	
350mm	L149	L141	24	
400mm	L169	L161	24	
450mm	L189	L181	24	
500mm	L209	L201	24	
550mm	L229	L221	24	
600mm	L249	L241	24	

Installation Dimensions(mm)

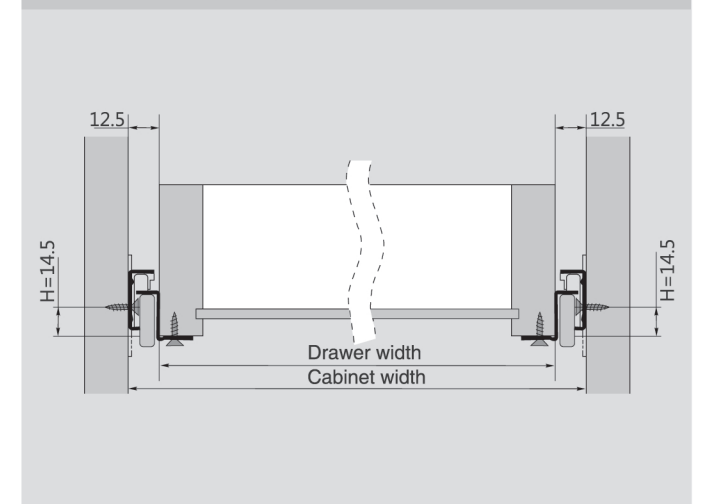

Screw Positions of the Slides(mm)

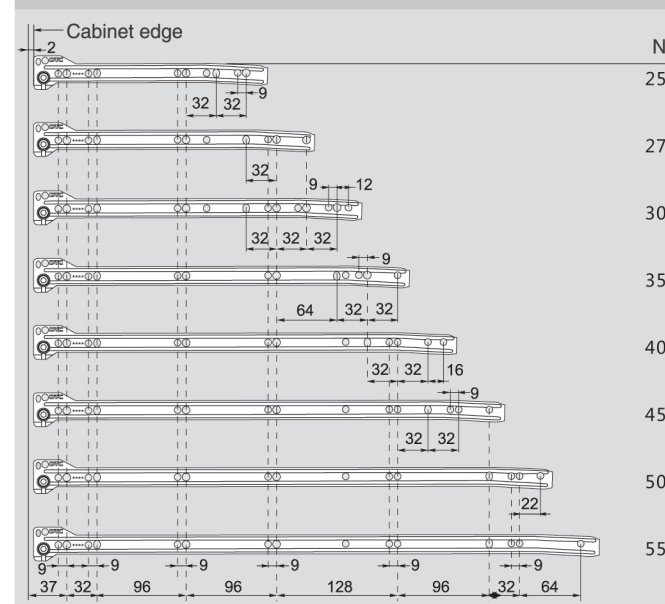

Drawer

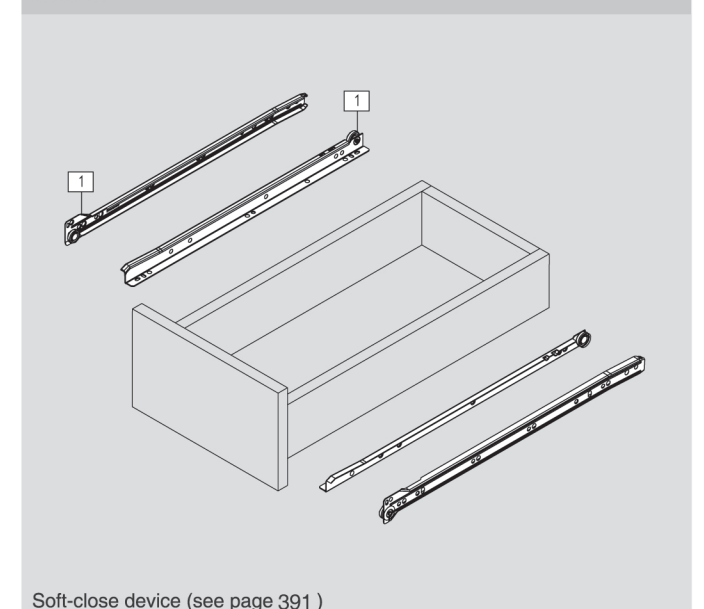



ORDER INFORMATION

Soft-close Device Installation for Single-wall Drawer

Slide length 250-300mm(10"-12")

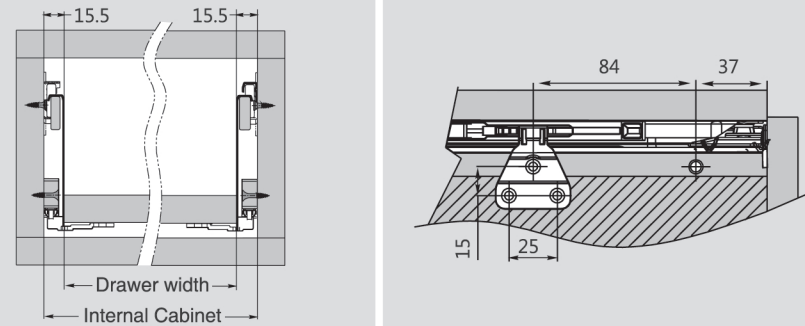

Item No.	W-HC1A	
Set/ctn	200	

Panel height(mm)	A1(mm)	B1(mm)
54	32	54
86	64	86
118	96	118
150	128	150

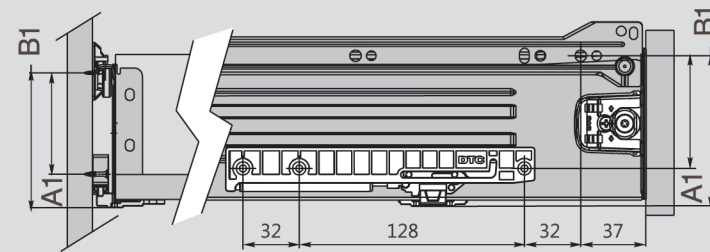

ORDER INFORMATION

Soft-close Device Installation for Roller Slide

Slide length 250-300mm(10"-12")

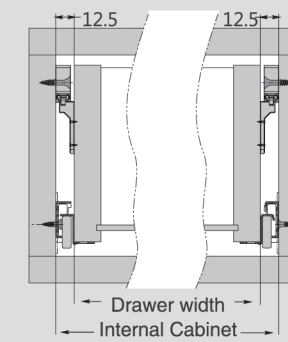

Item No.	W-HC1A-1	
Set/ctn	200	

H(mm)	A(mm)
14.5	37
13	35.5

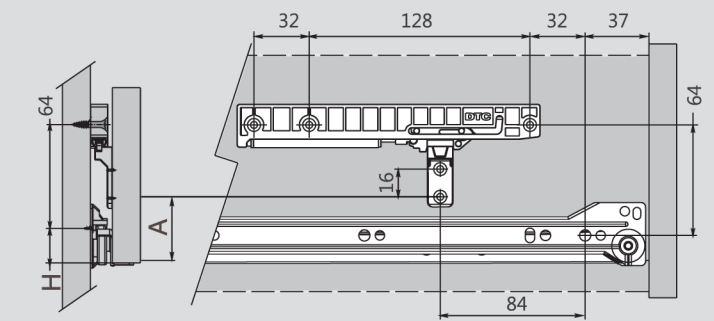

Soft-close Device Installation for Single-wall Drawer

Slide length 350-550mm(14"-22")

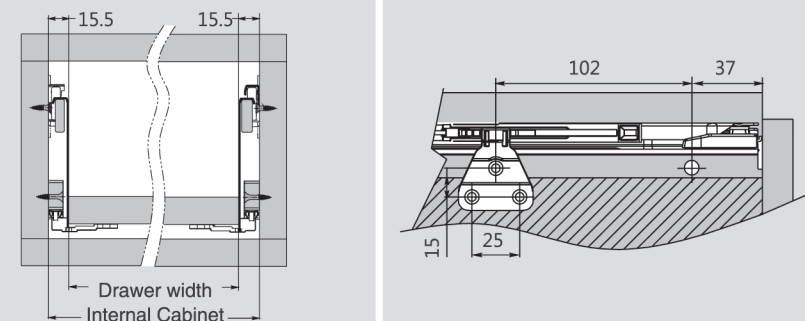

Item No.	W-HC1	
Set/ctn	200	

Panel height(mm)	A1(mm)	B1(mm)
54	32	54
86	64	86
118	96	118
150	128	150

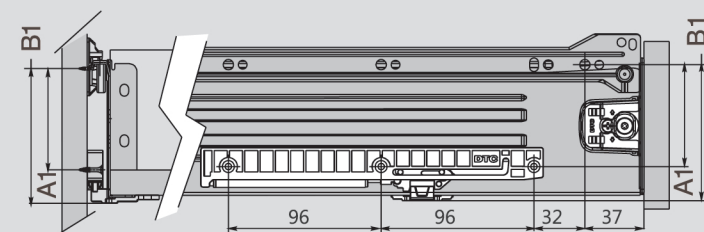

Soft-close Device Installation for Roller Slide

Slide length 350-600mm(14"-24")

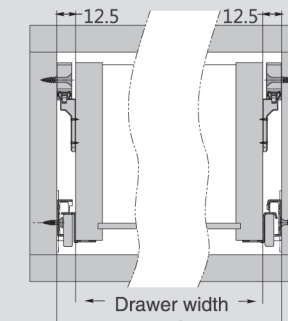

Item No.	W-HC1-1	
Set/ctn	200	

H(mm)	A(mm)
14.5	37
13	35.5

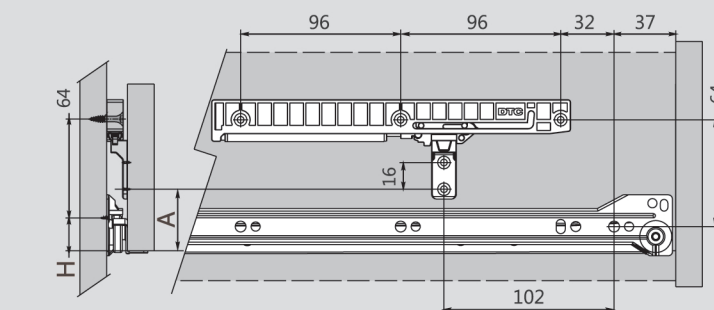



UNDERMOUNT
SLIDE SERIES

D-MOTION

D-MOTION

Soft-close and silent system

A Smooth Drawer



- DTC D-motion undermount slide, silent and soft-close
- Partial extension, Full extension, With peg/locking devices, A variety of options for users.
- Highly stable construction, verified durability



Quietness



Intelligence



Durability



Eco-Friendliness

D-MOTION

DS10 Series Full Extension Undermount Slides with Locking Device



PRODUCT



DESCRIPTION

- Load capacity: 35kg
- Finish: zinc plated
- Length: 250-600mm, full extension
- Silent system guarantees smooth run without noise
- 2D adjustment, up&down: 0-3mm, side: ± 1.5mm
- 3D adjustment, up&down: 0-3mm, side: ± 1.5mm, depth: 0-3mm
- Maximum drawer side thickness: 16mm

SPACE REQUIREMENT

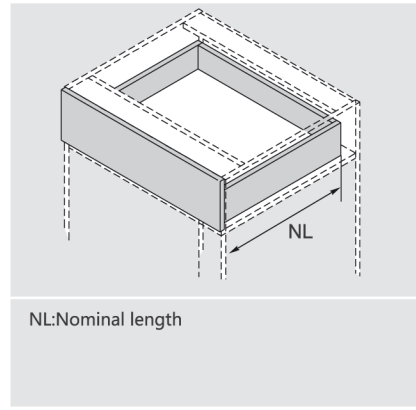

PLANNING

Installation Dimensions(mm)

NL=Nominal Slide Length
 LT=Internal Cabinet Depth
 LT=NL+3

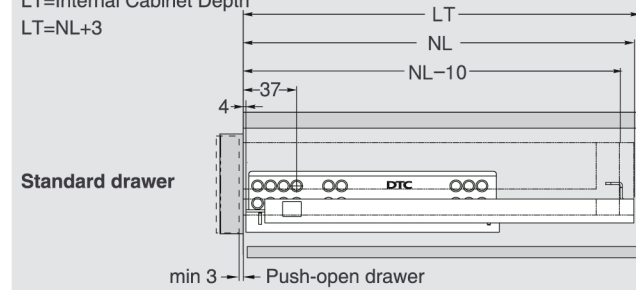

NL=Nominal Slide Length
 LT=Internal Cabinet Depth
 LT=NL+21

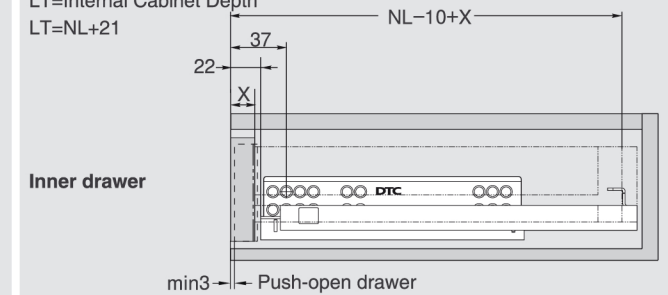

SOFT CLOSE DRAWER/PUSH-OPEN DRAWER

1 Slides (left/right)					
Pre-zinc Steel (F02)					
NL	Soft close item No.	Set/ctn	Push-open item No.	Set/ctn	
250mm	DS10250H	10	DF10250H	6	
270mm	DS10270H	10	DF10270H	6	
300mm	DS10300H	10	DF10300H	6	
350mm	DS10350H	10	DF10350H	6	
400mm	DS10400H	10	DF10400H	6	
450mm	DS10450H	10	DF10450H	6	
500mm	DS10500H	10	DF10500H	6	
550mm	DS10550H	10	DF10550H	6	
600mm	DS10600H	10	DF10600H	6	

	2D Locking Device (Left/Right)
	Grey(H11)
	Item No. ODSD03-A
	3D Locking Device (Left/Right)
	Grey(H11)
	Item No. ODSD04-A
	Rod for Push-open Synchronization (For cutting to size, 1100mm. Cutting: Internal cabinet width LW-172)
	Item No. HT0FH02

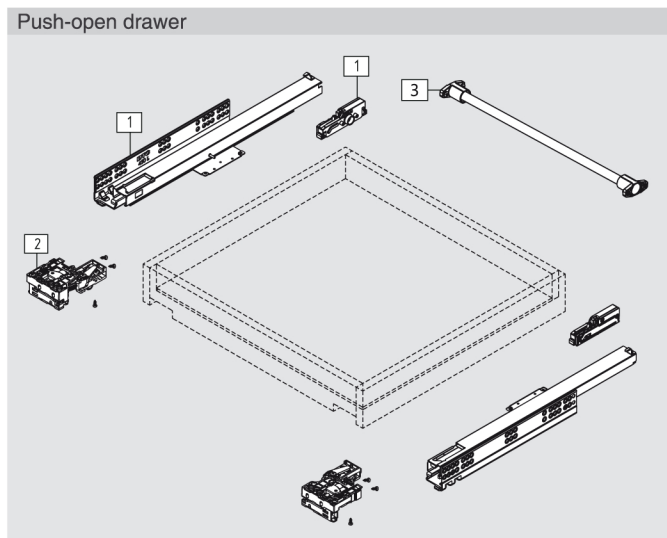
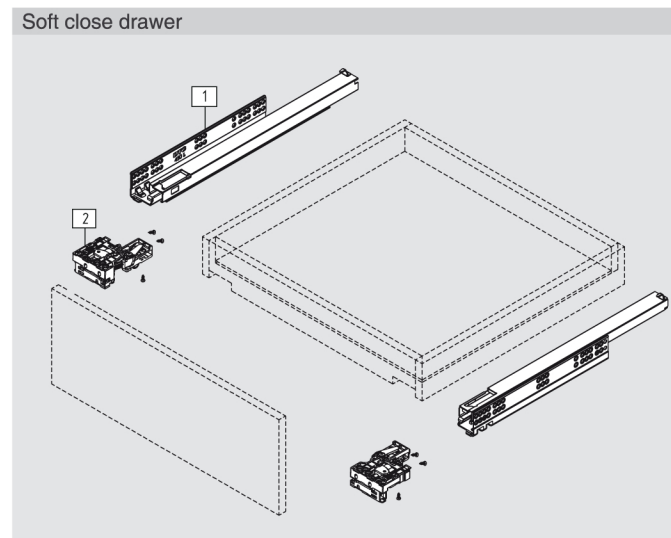

Screw Positions of the Slides(mm)

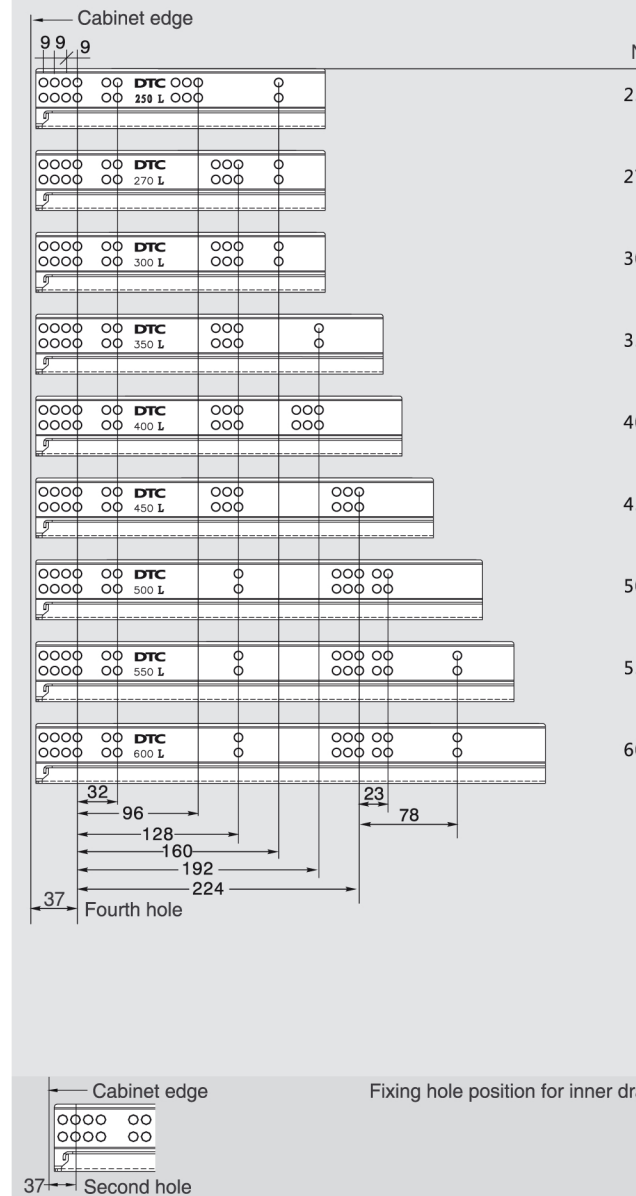

Installation Dimensions(mm)

SKW=Internal Drawer Width
 LW=Internal Cabinet Width

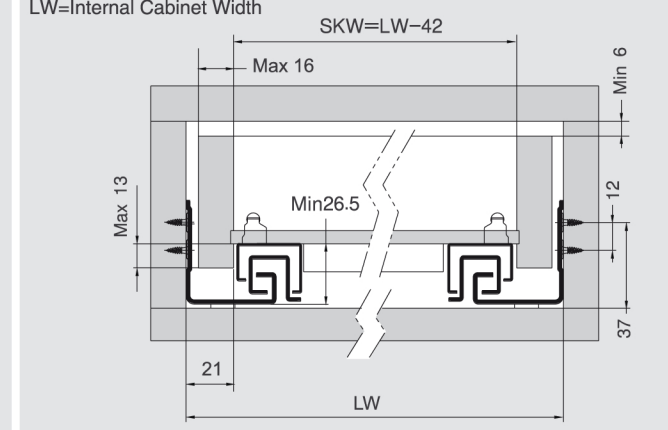

Drawer Back Preparation(mm)

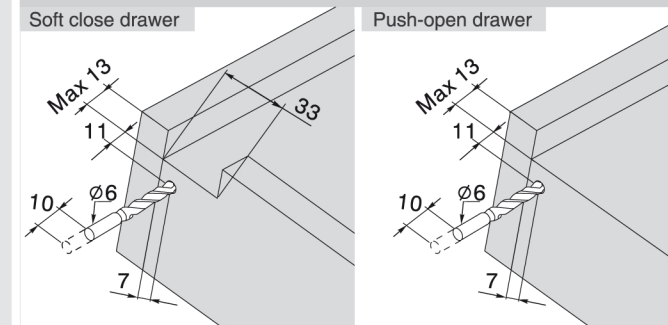

Locking Device Installation(mm)

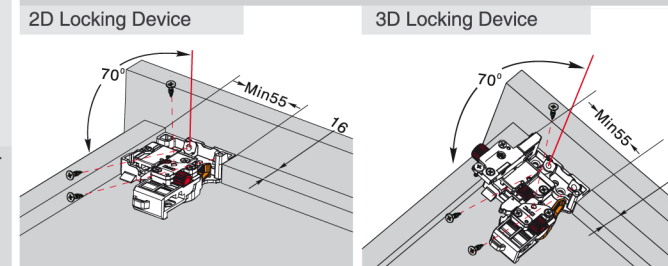

ASSEMBLY AND ADJUSTMENT

Assembly and Adjustment (for DS series)

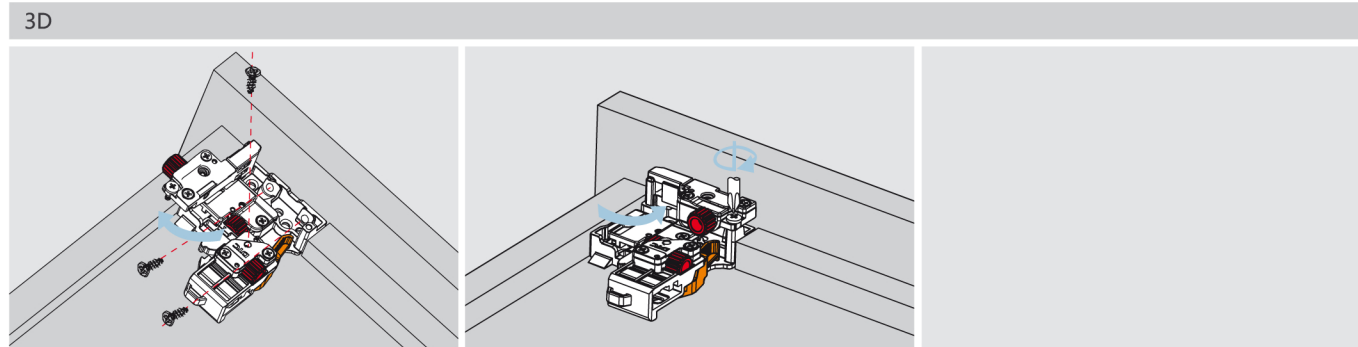

Move out the adjusting part and fix the locking device onto the drawer bottom.
Put the adjusting part back and tighten the screws.

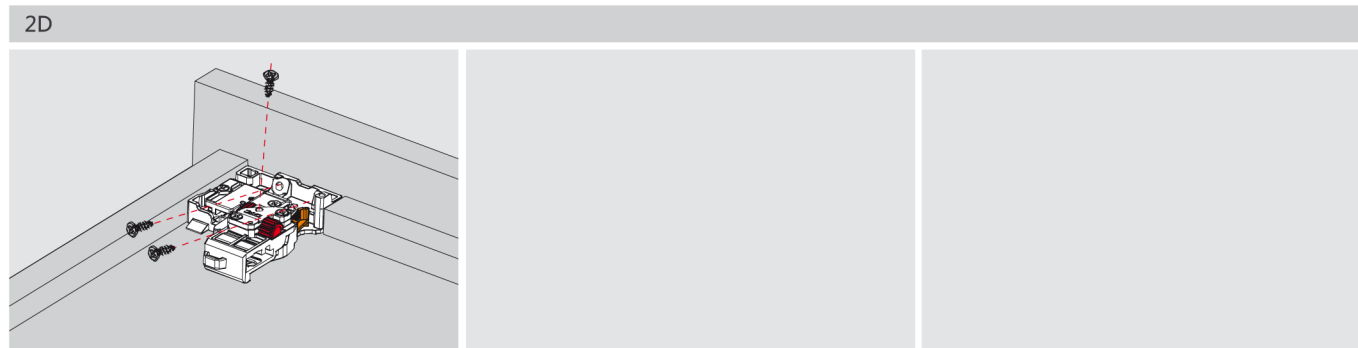

Fix the locking device onto the drawer bottom.

Drawer Assembly with 3D Adjustment Locking Device

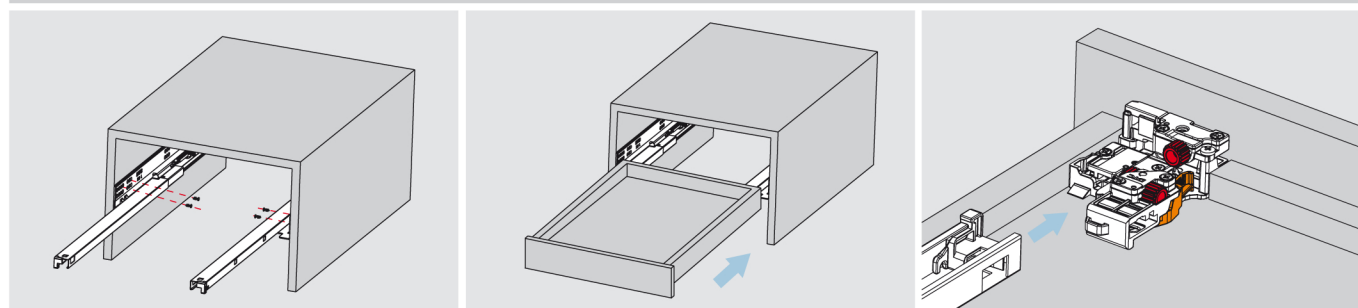

Fix the slide onto the cabinet.

Lay the drawer bottom onto the slide then push the drawer into the cabinet.

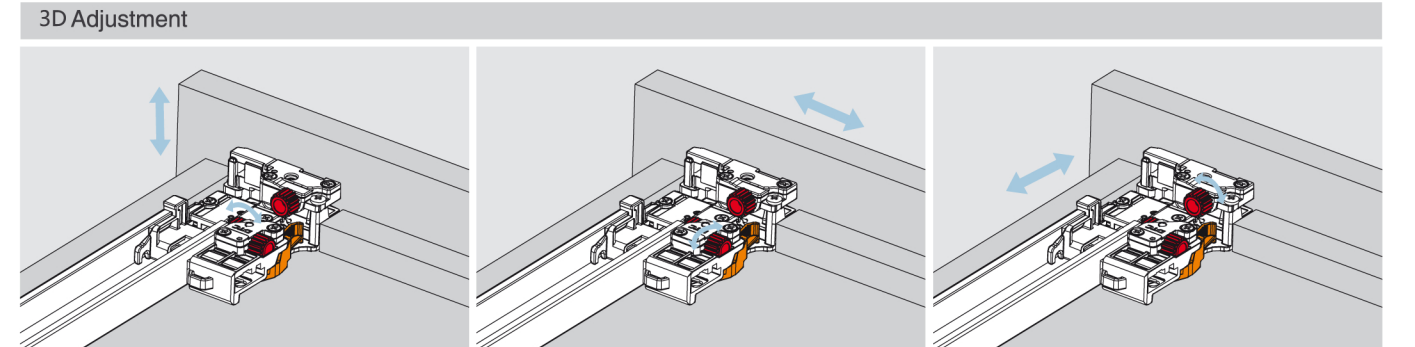

Up&down adjustment

Side adjustment

Depth adjustment

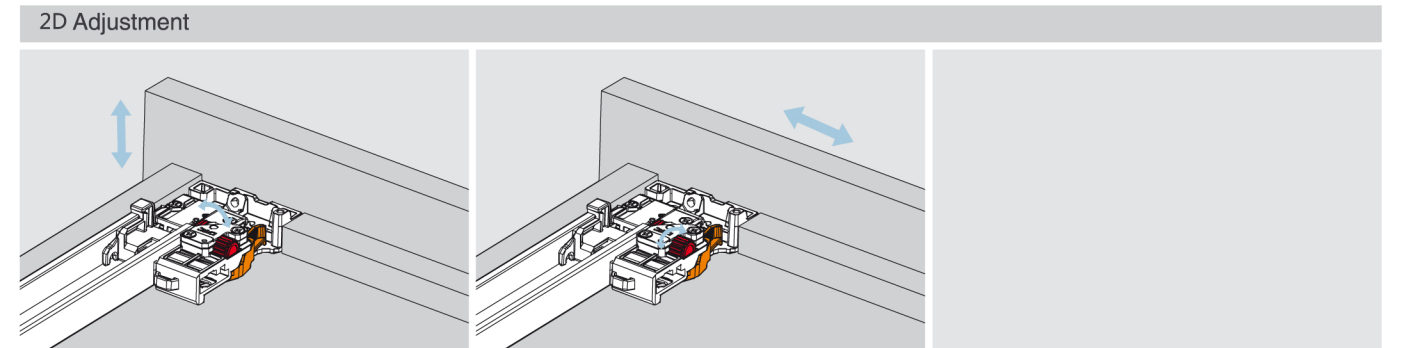

Up&down adjustment

Side adjustment

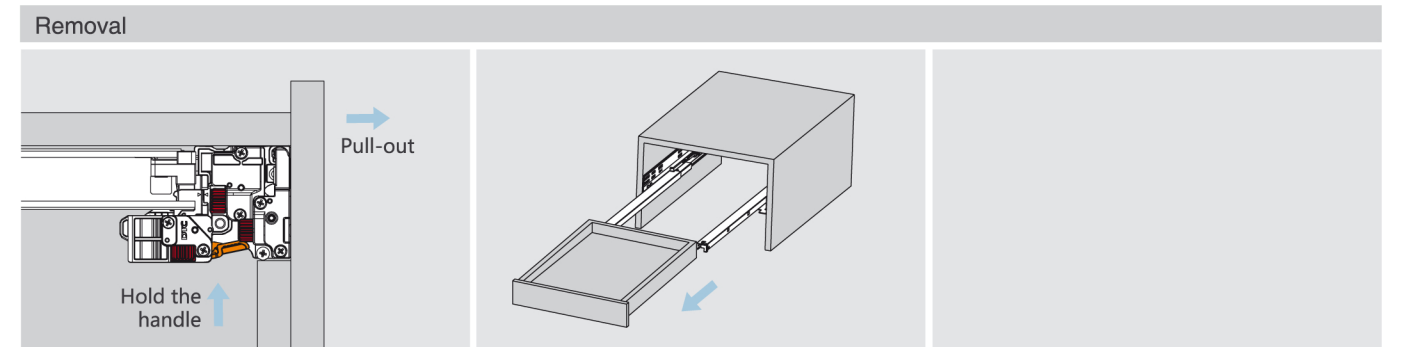

For removal, hold the handle and pull out the drawer.



PRODUCT



DESCRIPTION

- Load capacity: 35kg
- Finish: zinc plated
- Length: 250-600mm
- Full extension
- Tool free assembly and removal of drawer
- Silent system guarantees smooth run without noise
- Drawer up&down adjustment: 0~+3mm
- Maximum drawer side thickness:16mm

SPACE REQUIREMENT

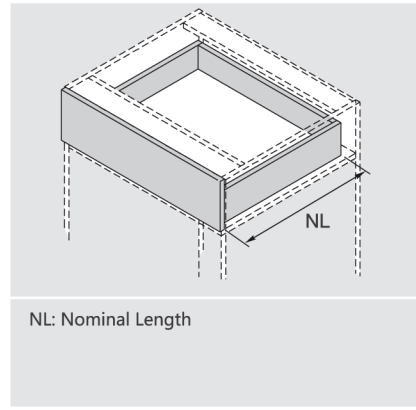

PLANNING

Installation Dimensions(mm)

NL=Nominal Slide Length LT=Internal Cabinet Depth LT=NL+3

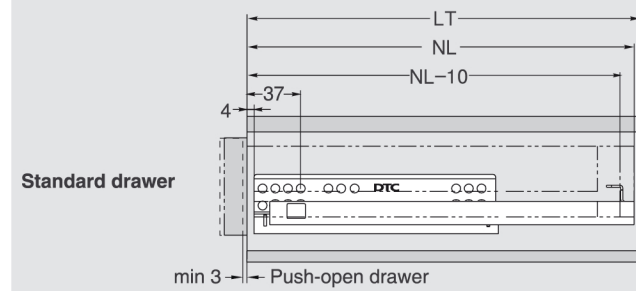

NL=Nominal Slide Length LT=Internal Cabinet Depth LT=NL+21

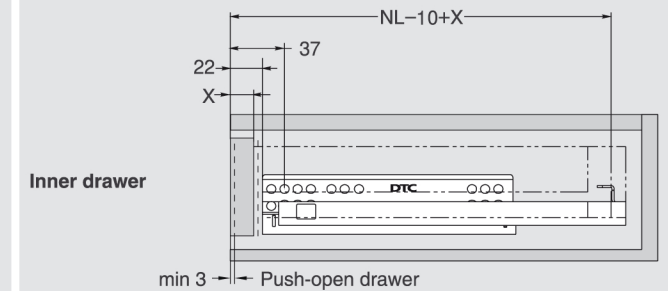

SOFT CLOSE DRAWER / PUSH-OPEN DRAWER

1		Slides (left/right)	
Pre-zinc Steel (F02)			
NL	Soft Close item No.	Set/ctn	Push-open item No.
250mm	SS10250H	10	FF10250HX
270mm	SS10270H	10	FF10270HX
300mm	SS10300H	10	FF10300HX
350mm	SS10350H1	10	FF10350HX
400mm	SS10400H1	10	FF10400HX
450mm	SS10450H1	10	FF10450HX
500mm	SS10500H1	10	FF10500HX
550mm	SS10550H1	10	FF10550HX
600mm	SS10600H1	10	FF10600HX

2		Locking Device (left/right)	
Grey(H11)			
Item No.		0SSLD01-A	

3		Rod for Push-open Synchronization /For cutting to size,1100mm.Cutting:Internal cabinet width LW-172	
Item No.		HT0FH02	

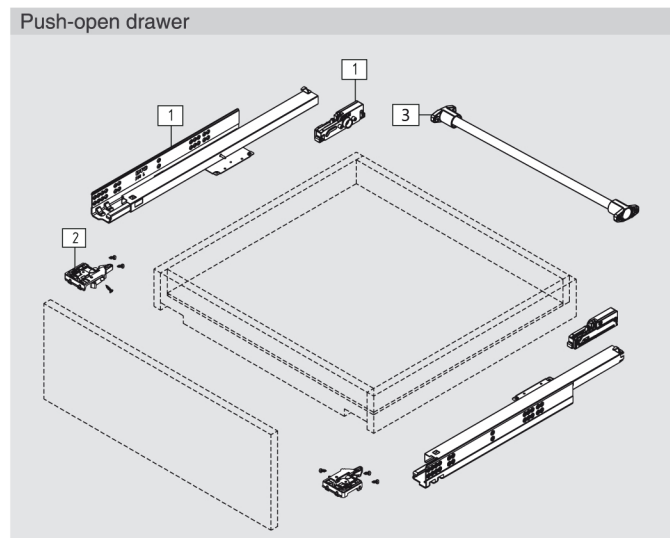
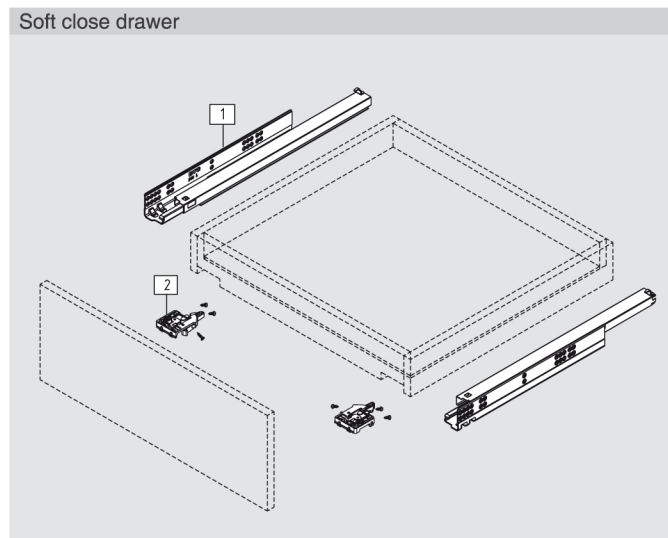

Screw Positions of the Slides(mm)

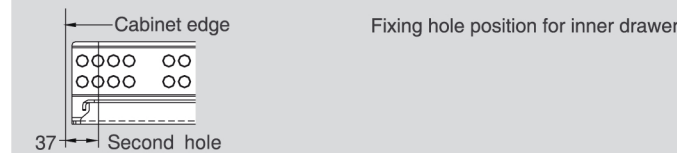
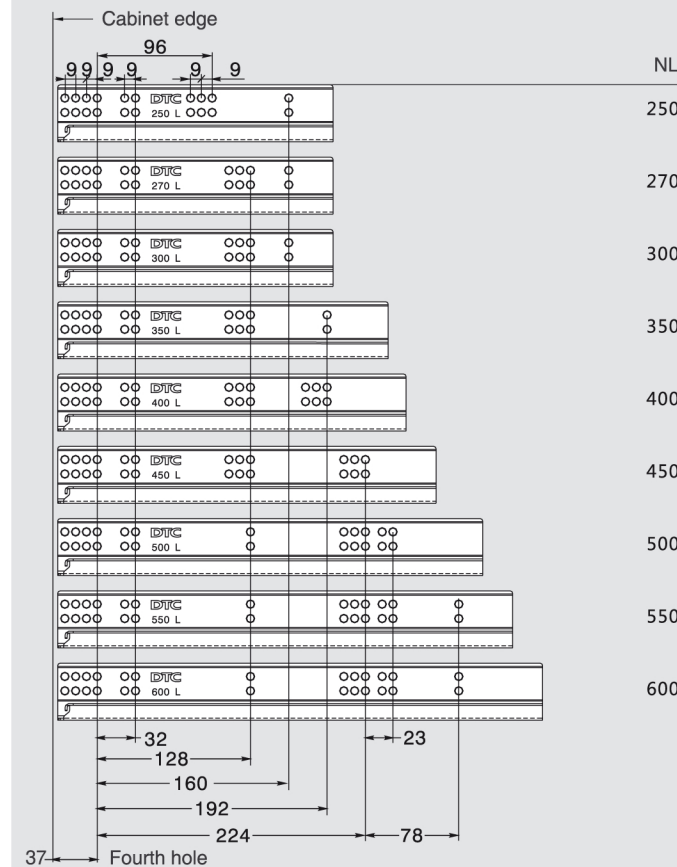

Installation Dimensions(mm)

SKW=Internal Drawer Width
LW=Internal Cabinet Width

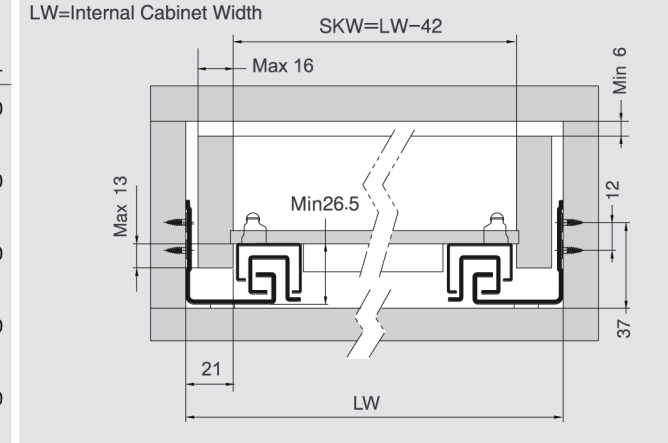

Drawer Back Preparation(mm)

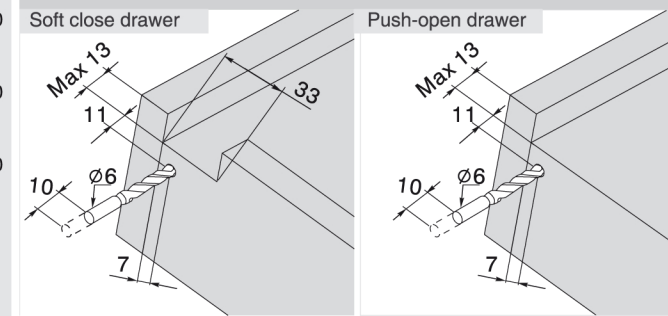

Locking Device Installation(mm)

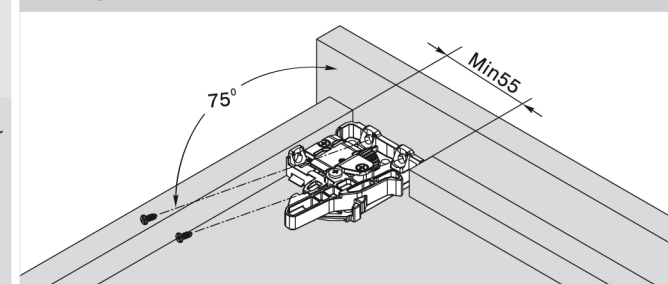



PRODUCT



DESCRIPTION

- Load capacity: 35kg
- Finish: zinc plated
- Length: 250-600mm
- Full extension
- Tool free assembly and removal of drawer
- Silent system guarantees smooth run without noise
- Drawer up&down adjustment: 0~+4mm
- Maximum drawer side thickness:16mm

SPACE REQUIREMENT

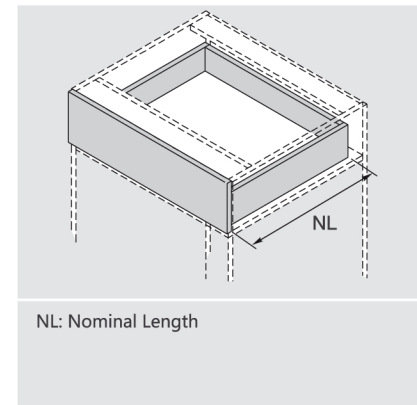

PLANNING

Installation Dimensions(mm)

NL=Nominal Slide Length LT=Internal Cabinet Depth LT=NL+3

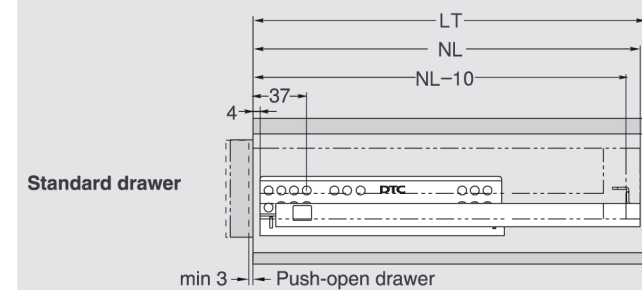

NL=Nominal Slide Length LT=Internal Cabinet Depth LT=NL+21

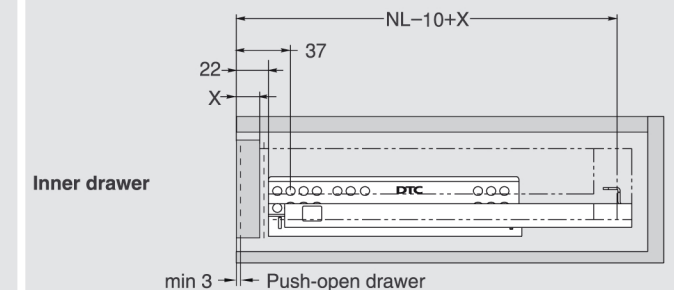

SOFT CLOSE DRAWER / PUSH-OPEN DRAWER

1		Slides (left/right)	
Pre-zinc Steel (F02)			
NL	Soft Close item No.	Set/ctn	Push-open item No.
250mm	SS10C250H	10	FF10C250HX
270mm	SS10C270H	10	FF10C270HX
300mm	SS10C300H	10	FF10C300HX
350mm	SS10C350H1	10	FF10C350HX
400mm	SS10C400H1	10	FF10C400HX
450mm	SS10C450H1	10	FF10C450HX
500mm	SS10C500H1	10	FF10C500HX
550mm	SS10C550H1	10	FF10C550HX
600mm	SS10C600H1	10	FF10C600HX

2		Locking Pin	
Grey(H11)			
Item No.		SJS01	

3		Rod for Push-open Synchronization /For cutting to size,1100mm.Cutting:Internal cabinet width LW-172	
Item No.		HT0FH02	

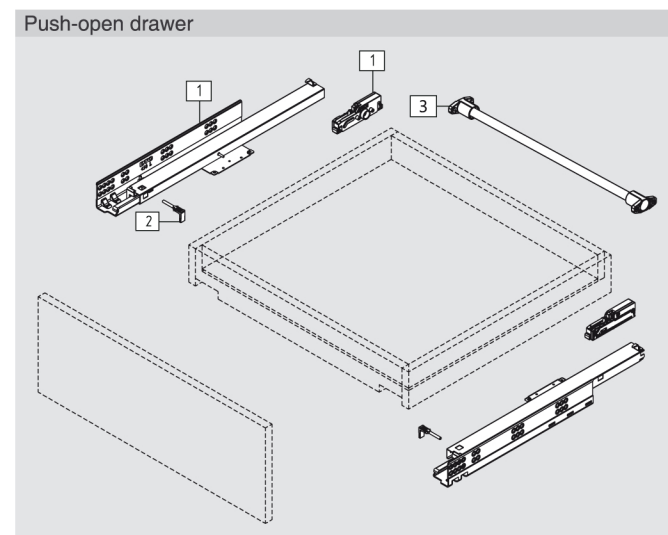
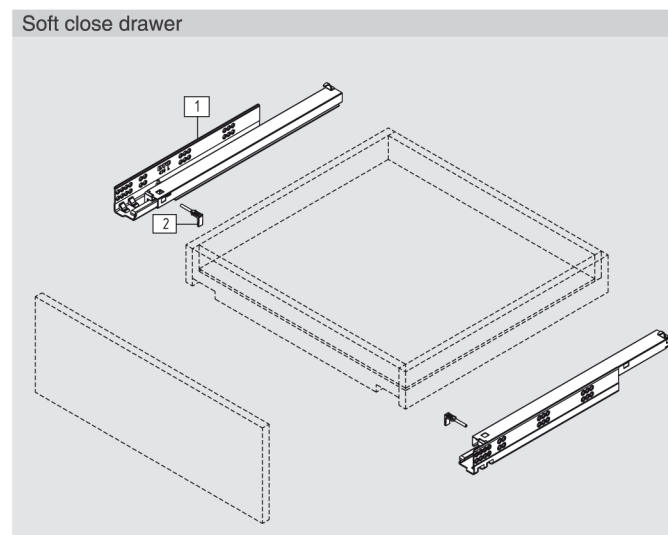

Screw Positions of the Slides(mm)

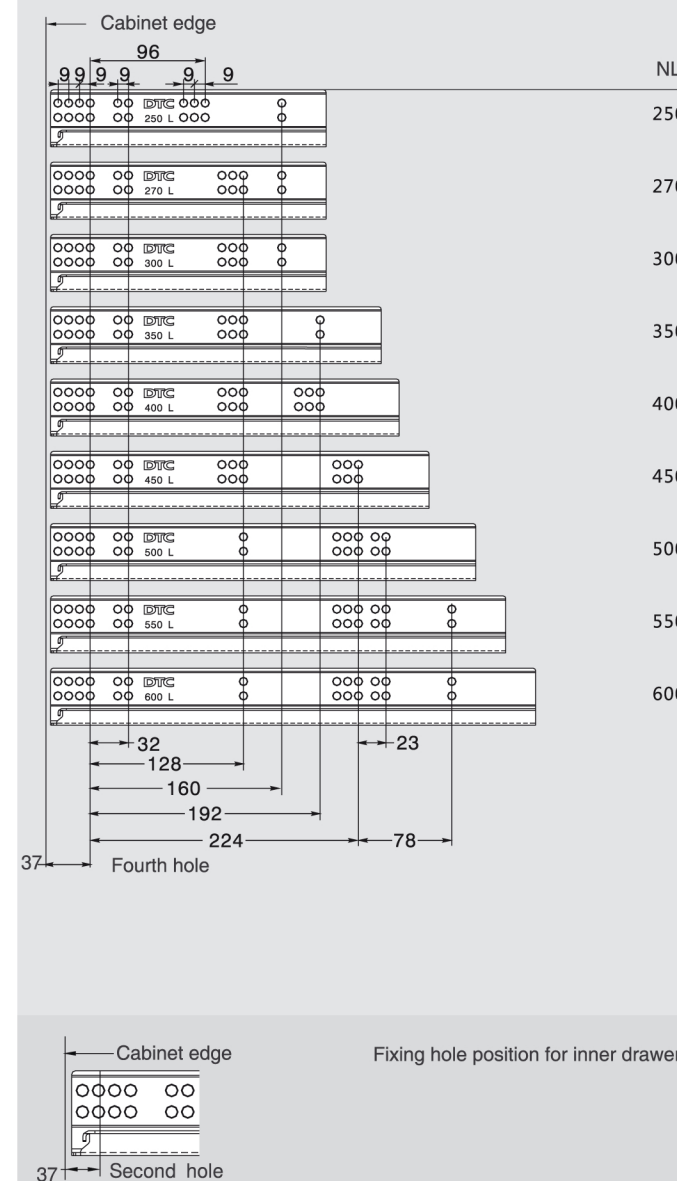

Installation Dimensions(mm)

SKW=Internal Drawer Width
LW=Internal Cabinet Width

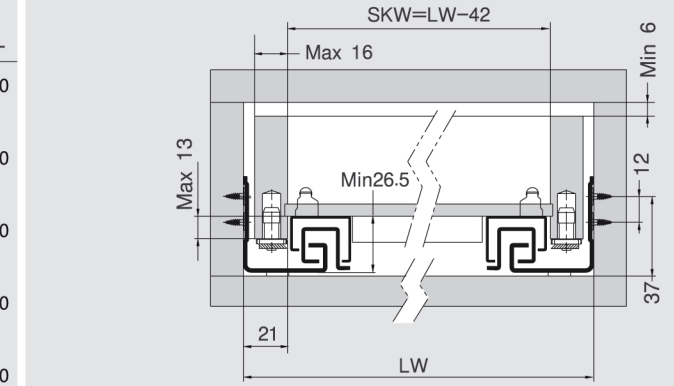

Drawer Back Preparation(mm)

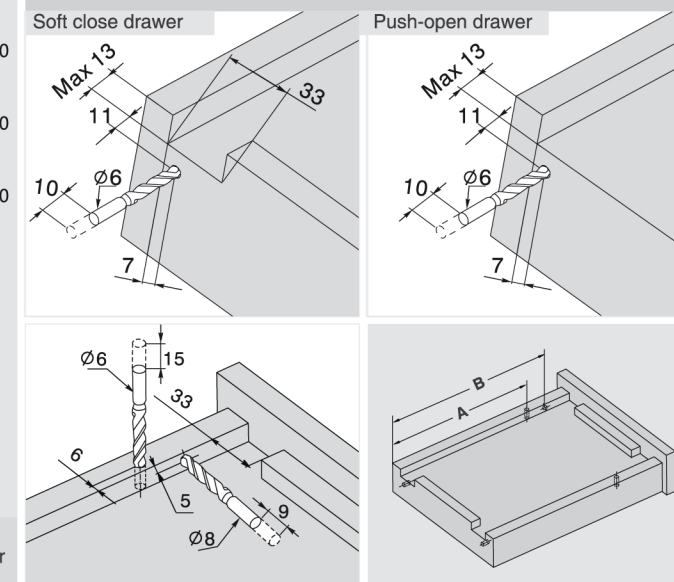

NL (mm)	250	270	300	350	400	450	500	550	600
A (mm)	190	205	245	270	305	330	355	390	415
B (mm)	200.5	215.5	255.5	280.5	319.5	369.5	419.5	469.5	519.5

ASSEMBLY AND ADJUSTMENT

Assembly and Adjustment
(for D-MOTION Full Extension Undermount Slides)



Drawer Assembly with Locking Device

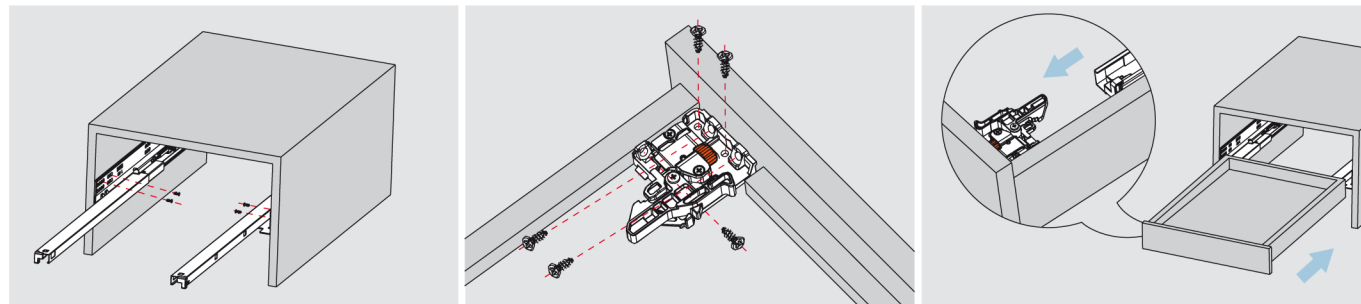

Fix the slide onto the cabinet.

Fix the locking device onto the drawer bottom.

Lay the drawer bottom onto the slide then push the drawer into the cabinet.

Removal with Locking Device

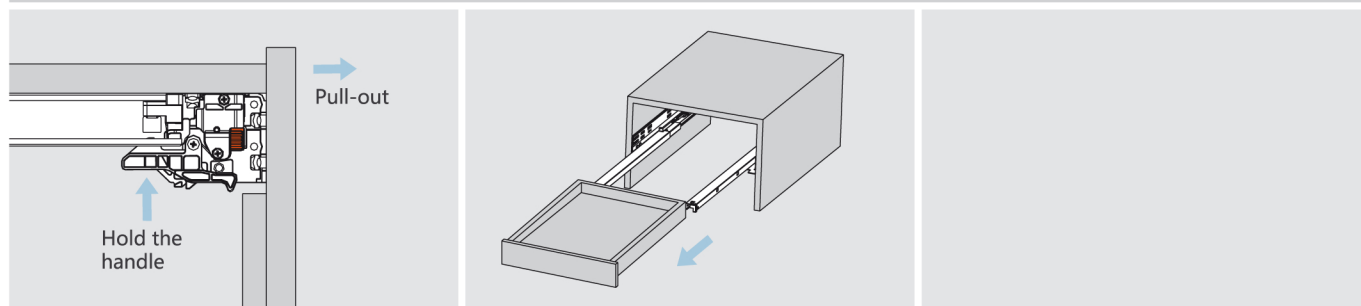

For removal, hold the handle and pull out the drawer.

Drawer Assembly with Peg

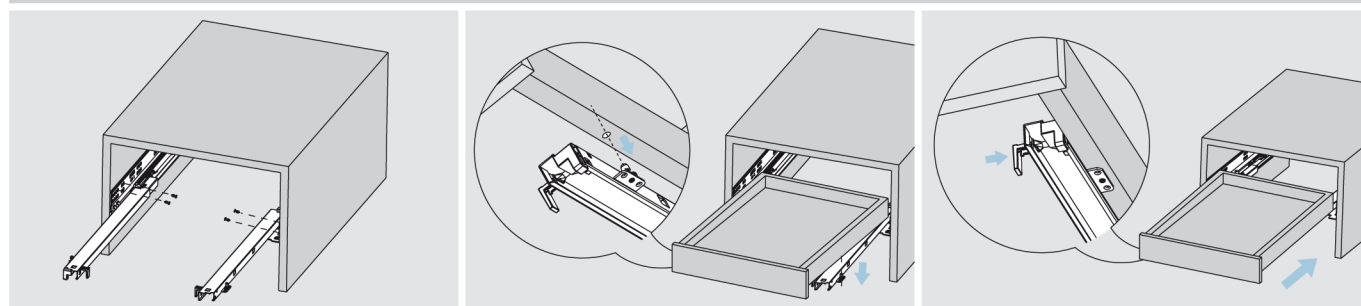

Fix the slide onto the cabinet.

Pull out the drawer member of the slide from the cabinet, lay the drawer onto the slide.

Press the locking pin into the drawer side to lock the position of the drawer.

Removal with Peg

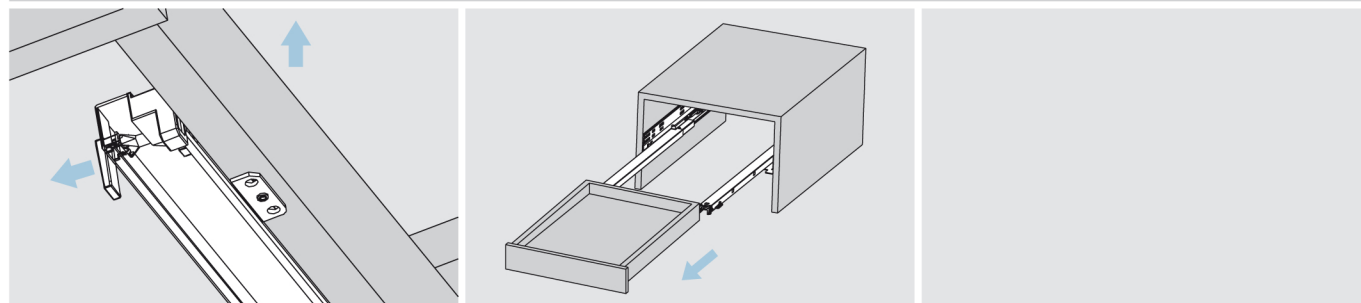

For removal, pull out the locking pin from the drawer side. Lift the drawer and pull it out from the cabinet.

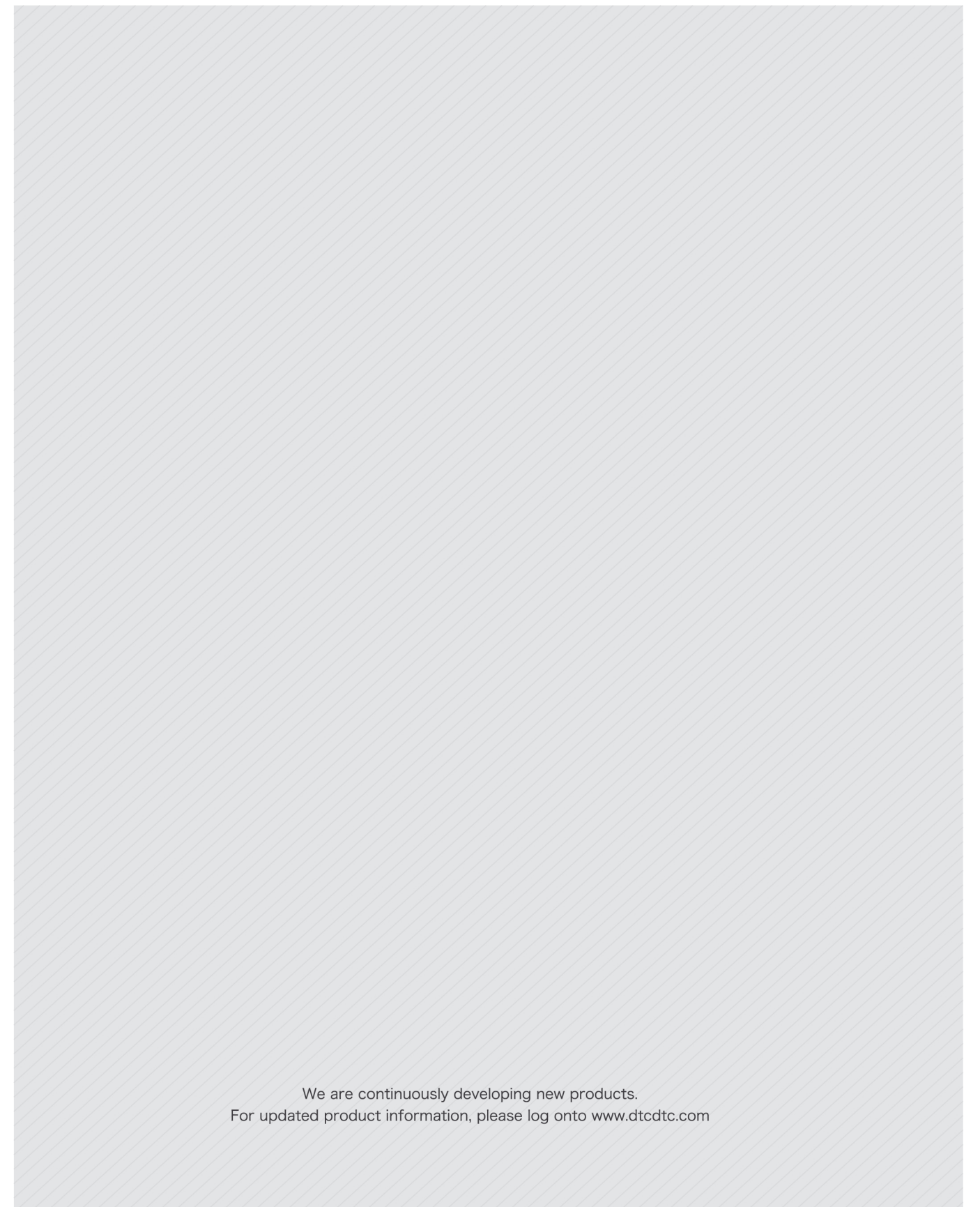

We are continuously developing new products.
For updated product information, please log onto www.dtcetc.com



PRODUCT



DESCRIPTION

- Load capacity: 25kg
- Finish: zinc plated
- Length: 250-600mm
- Partial extension
- Drawer up&down adjustment: 0~+3mm
- Tool free assembly and removal of drawer
- Silent system guarantees smooth run without noise
- Maximum drawer side thickness: 16mm

SPACE REQUIREMENT

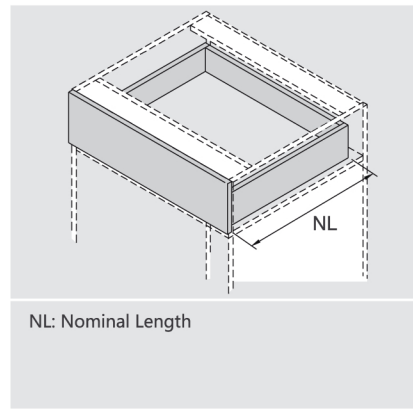

PLANNING

Installation Dimensions(mm)

NL=Nominal Slide Length
LT=Internal Cabinet Depth
LT=NL+3

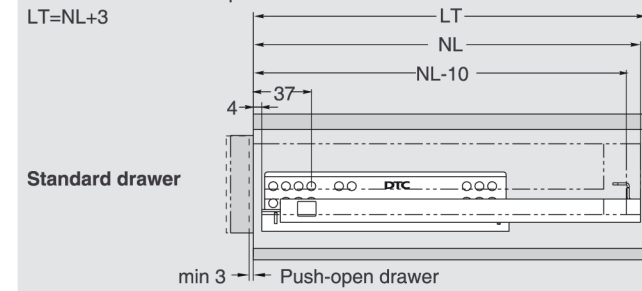

NL=Nominal Slide Length
LT=Internal Cabinet Depth
LT=NL+21

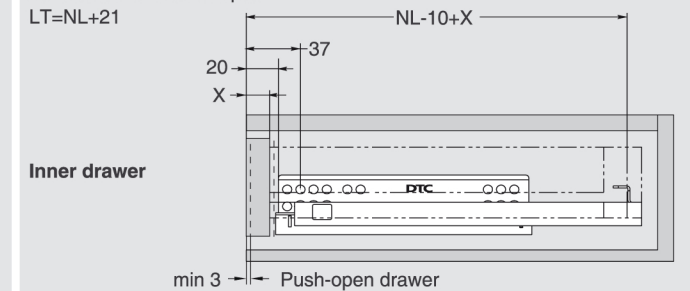

SOFT CLOSE DRAWER/PUSH-OPEN DRAWER

1 Slides (left/right)				
Pre-zinc Steel (F02)				
NL	Soft close item No.	Push-open item No.	Set/ctn	
250mm	G10C-250-H-X	G02A-250	10	
270mm	G10C-270-H-X	G02A-270	10	
300mm	G10C-300-H-X	G02A-300	10	
350mm	G10C-350-H-X	G02A-350	10	
400mm	G10C-400-H-X	G02A-400	10	
450mm	G10C-450-H-X	G02A-450	10	
500mm	G10C-500-H-X	G02A-500	10	
550mm	G10C-550-H-X	G02A-550	10	
600mm	G10C-600-H-X	G02A-600	10	

2 Locking Device (left/right)	
Item No.	0GLD01-A
Grey(H11)	

2 Locking Device (left/right)	
Item No.	0GLD01
Grey(H11)	

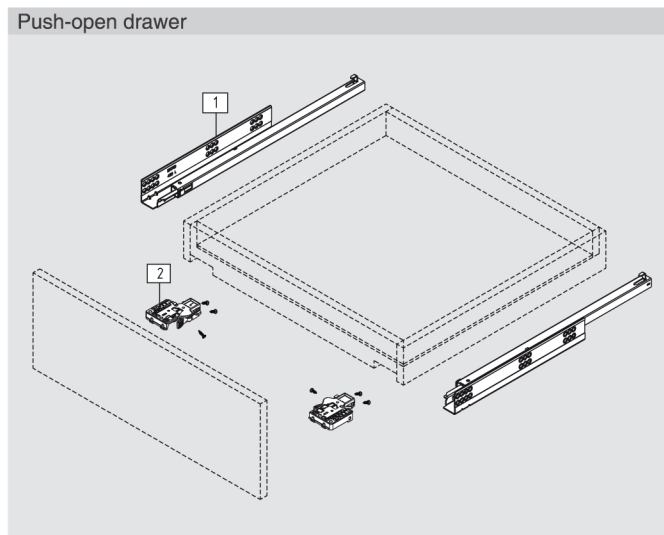
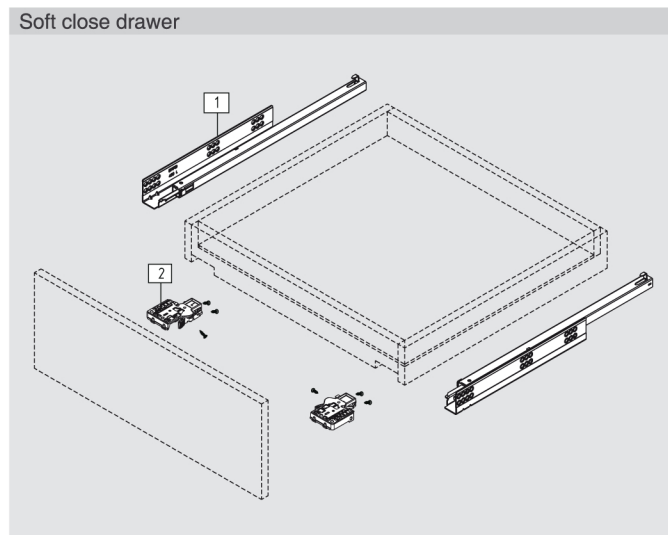

Fixing Hole Position for Inner Drawer(mm)

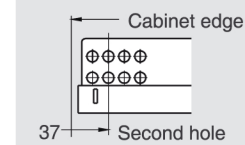

Installation Dimensions(mm)

LW=Internal Cabinet Width

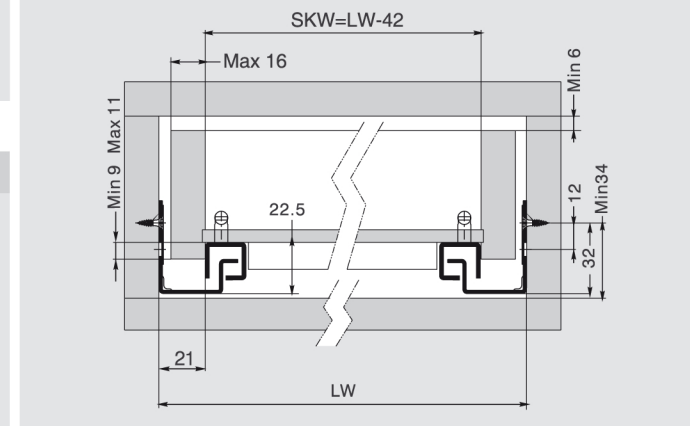

Screw Positions of the Slides(mm)

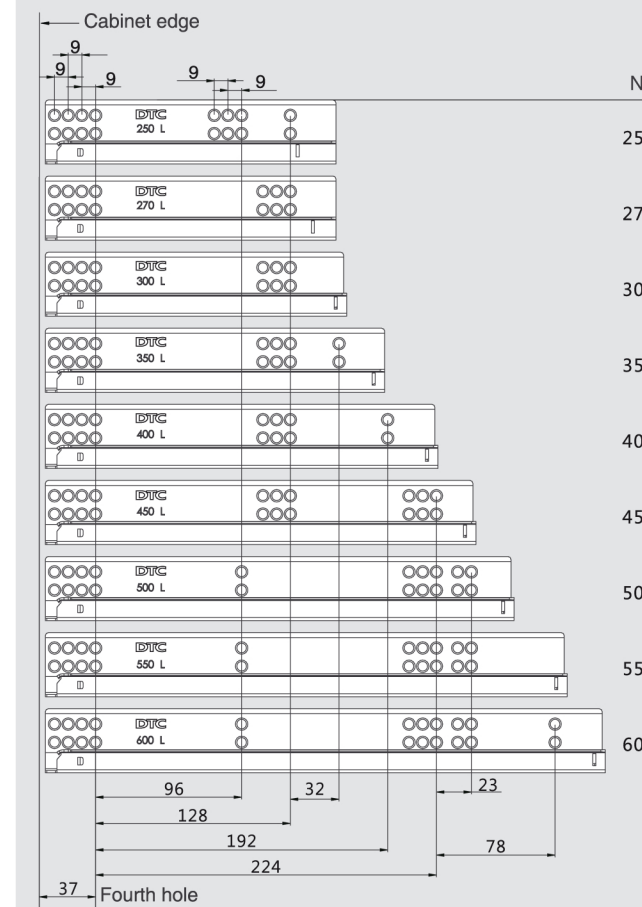

Drawer Back Preparation(mm)

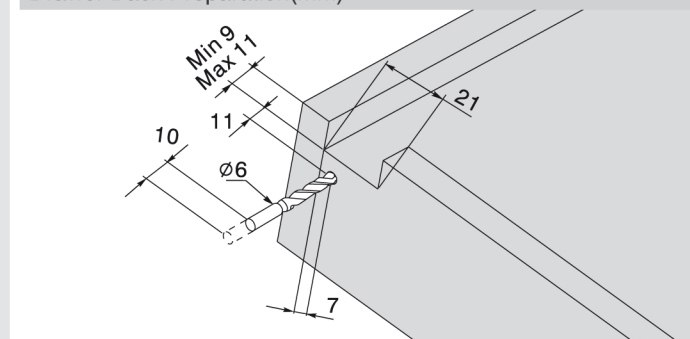

Locking Device Installation(mm)

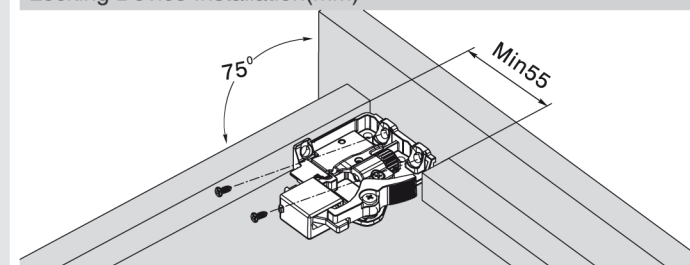



PRODUCT



DESCRIPTION

- Load capacity: 25kg
- Finish: zinc plated
- Length: 250-600mm
- Partial extension
- Drawer up&down adjustment: 0~+4mm
- Tool free assembly and removal of drawer
- Silent system guarantees smooth run without noise
- Maximum drawer side thickness: 16mm

SPACE REQUIREMENT

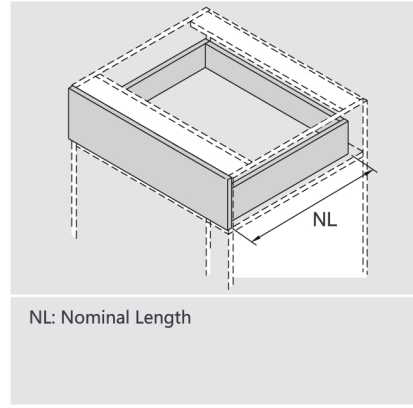

PLANNING

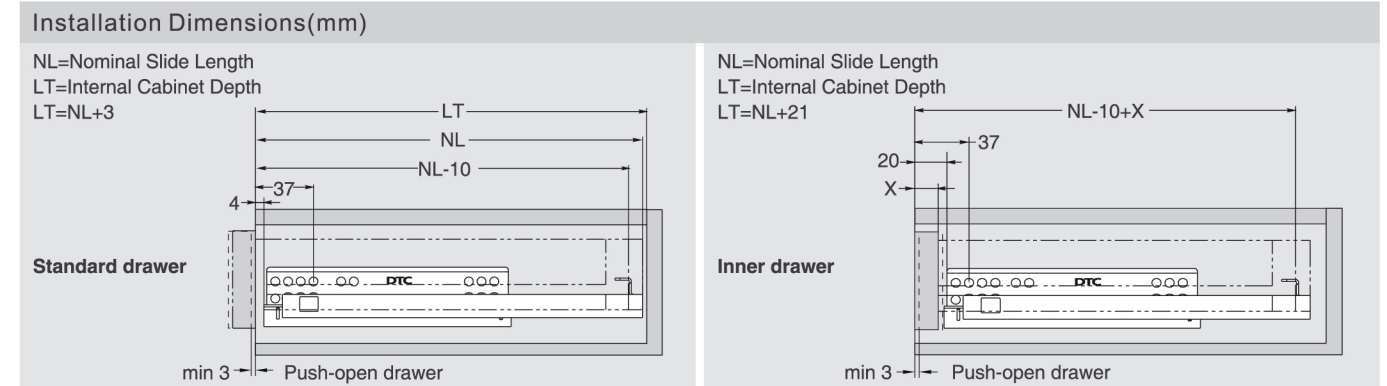

SOFT CLOSE DRAWER/PUSH-OPEN DRAWER

NL	Soft close		Set/ctn
	item No.	item No.	
250mm	G10-250-H-X	G02-250	10
270mm	G10-270-H-X	G02-270	10
300mm	G10-300-H-X	G02-300	10
350mm	G10-350-H-X	G02-350	10
400mm	G10-400-H-X	G02-400	10
450mm	G10-450-H-X	G02-450	10
500mm	G10-500-H-X	G02-500	10
550mm	G10-550-H-X	G02-550	10
600mm	G10-600-H-X	G02-600	10

Item No.	GJS02
Grey(H11)	

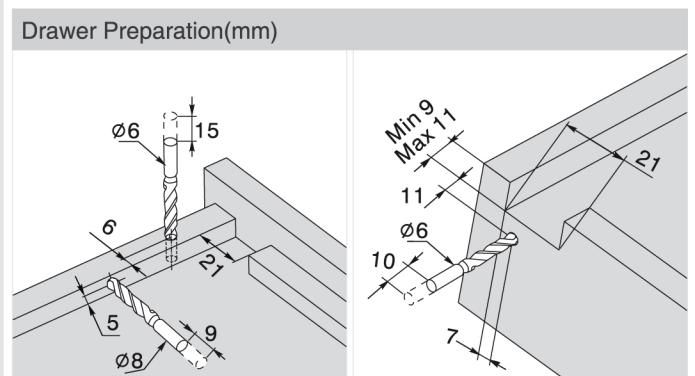
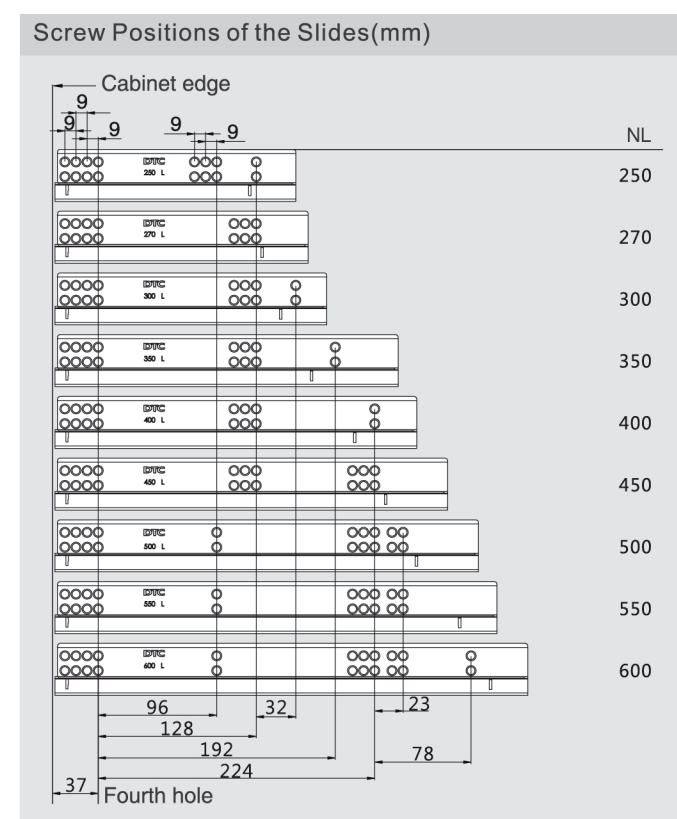
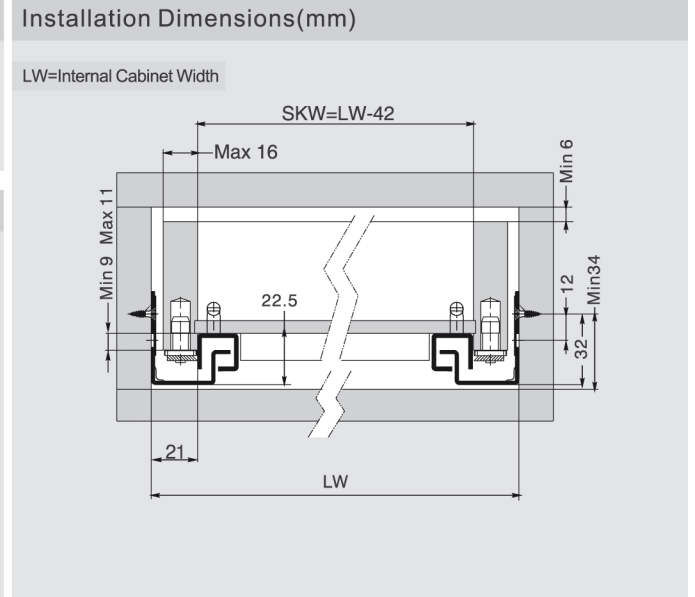
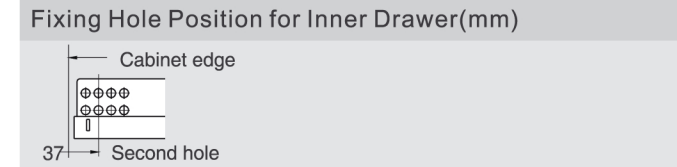
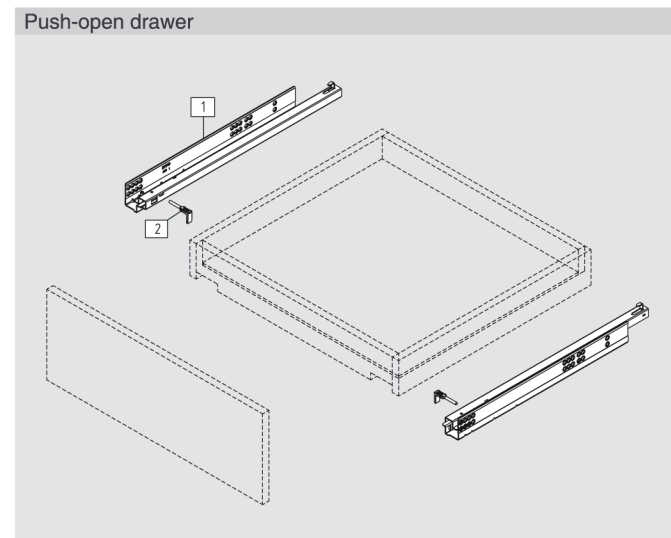
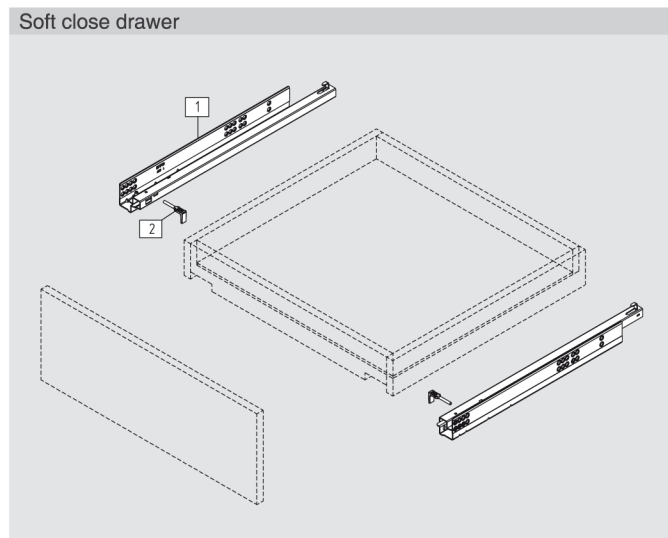

NL (mm)	A (mm)	B (mm)
250	220	188
270	230	198
300	245	213
350	270	238
400	305	273
450	330	298
500	355	323
550	390	358
600	415	383

NL (mm)	B (mm)	A (mm)	C (mm)
250	240	221	189
270	260	241	209
300	290	271	239
350	340	321	289
400	390	371	339
450	440	421	389
500	490	471	439
550	540	521	489
600	590	571	539

ASSEMBLY AND ADJUSTMENT

Assembly and Adjustment
(for D-MOTION Partial Extension Undermount Slides)



Drawer Assembly with Locking Device

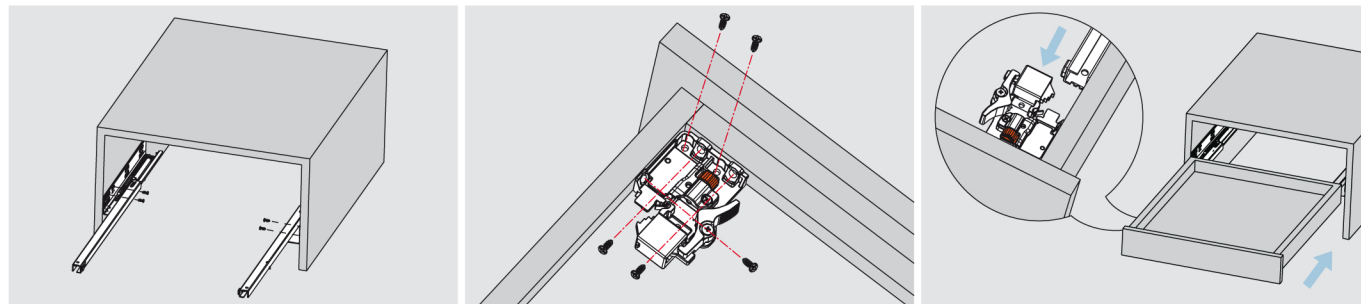

Fix the slide onto the cabinet.

Fix the locking device onto the drawer bottom.

Lay the drawer bottom onto the slide then push the drawer into the cabinet.

Removal with Locking Device

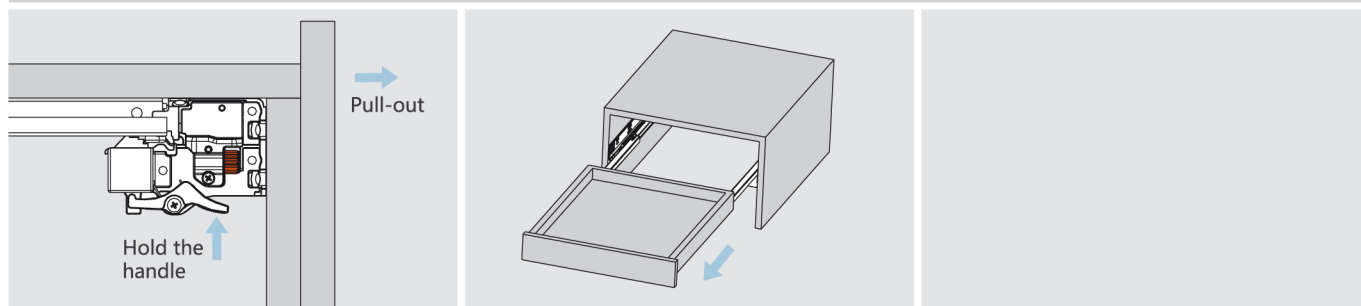

For removal, hold the handle and pull out the drawer.

Drawer Assembly with Peg

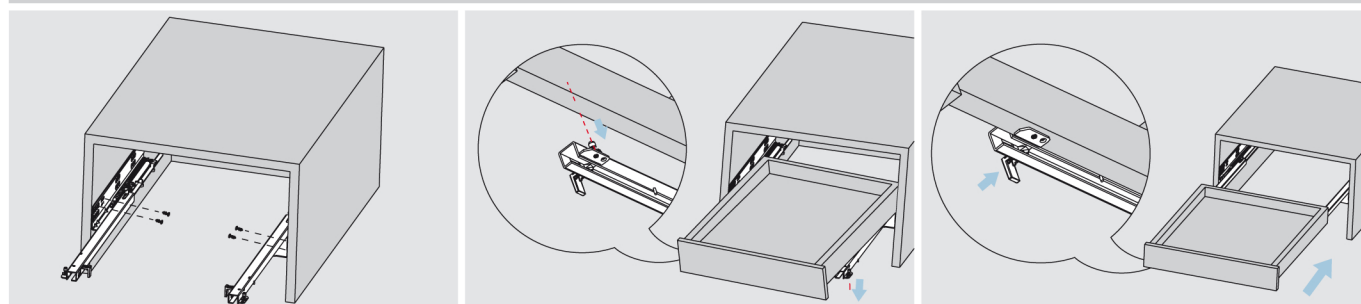

Fix the slide onto the cabinet.

Pull out the drawer member of the slide from the cabinet, lay the drawer onto the slide.

Press the locking pin into the drawer side to lock the position of the drawer.

Removal with Peg

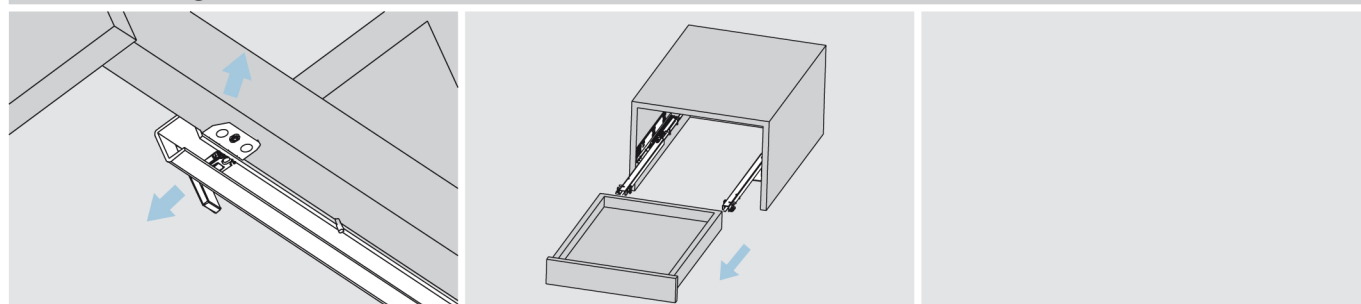

For removal, pull out the locking pin from the drawer side. Lift the drawer and pull it out from the cabinet.

We are continuously developing new products.
For updated product information, please log onto www.dtcetc.com

ACCESSORY

Marking Template (for Drawer Slide System)

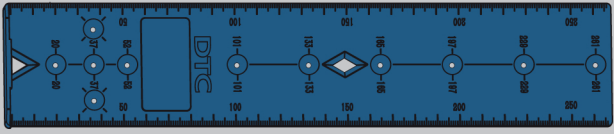

Order Information

	Universal Marking Template
	Blue (H23)
Item No.	DT02
Pcs/ctn	100

Marking Position

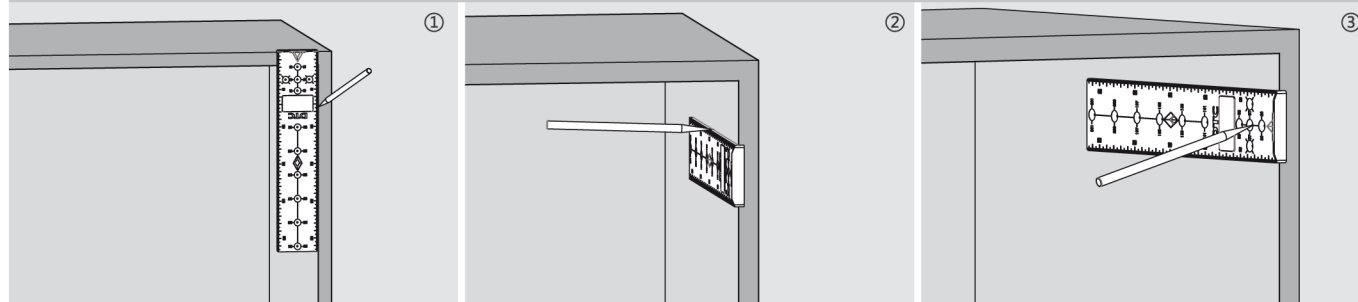

①② Mark the vertical position of mounting hole

③ Mark the longitudinal position of mounting hole

Application

Drawer Slide System: Double-wall Drawer System / Undermount Slide Series / Ball Bearing Slide Series

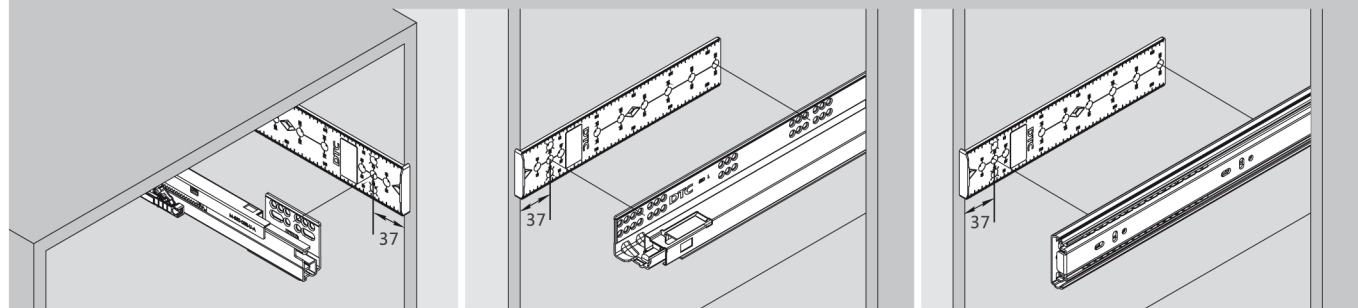

Double-wall Drawer System

Undermount Slide Series

Ball Bearing Slide Series

Mounting Hole Positions for Drawer Slide System

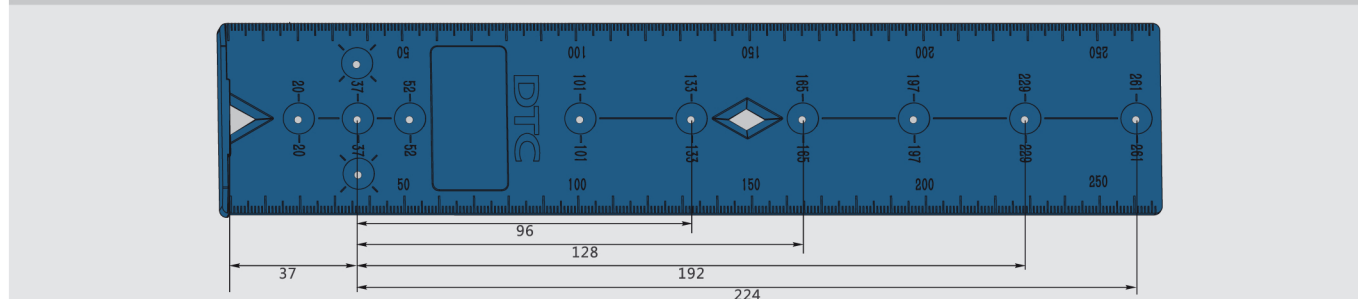

Order Information

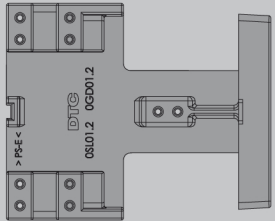
	Undermount Slide Drawer Assembly Tool
Item No.	DT01
Pcs/ctn	20

Assembly Tool Dimensions(mm)

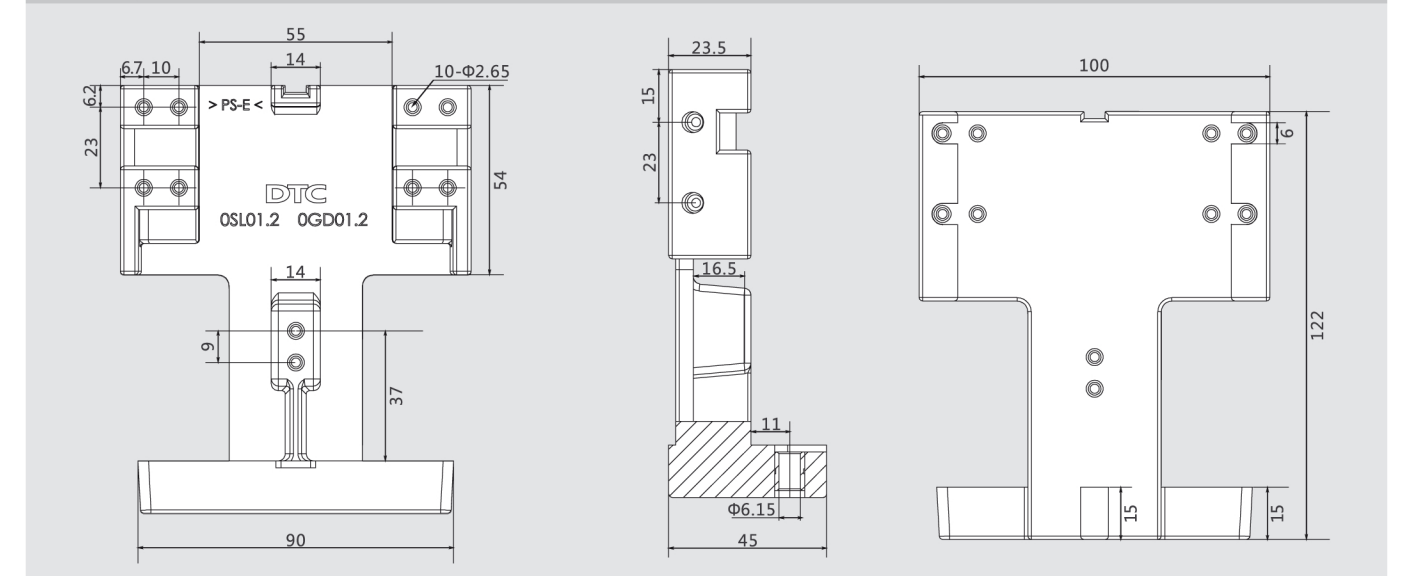

Drawer Assembly

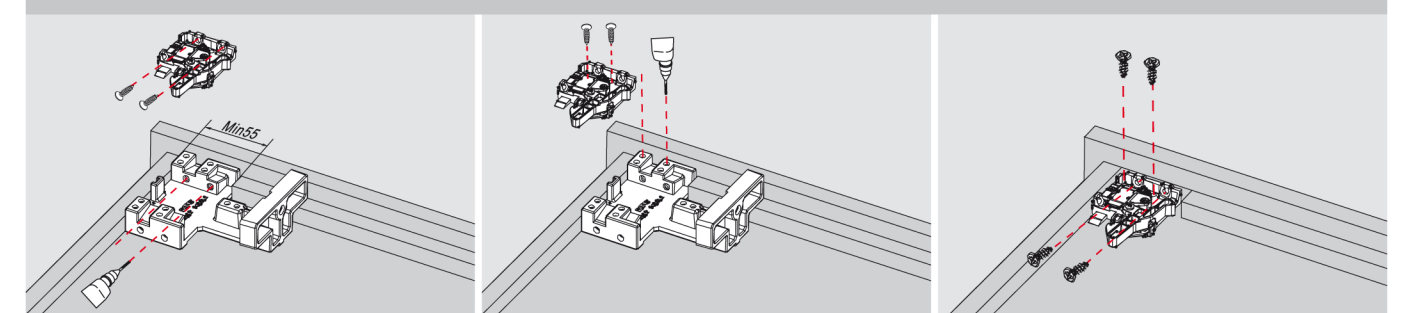

Mark the position of the locking device and fix the locking device onto the drawer bottom

Drawer Assembly

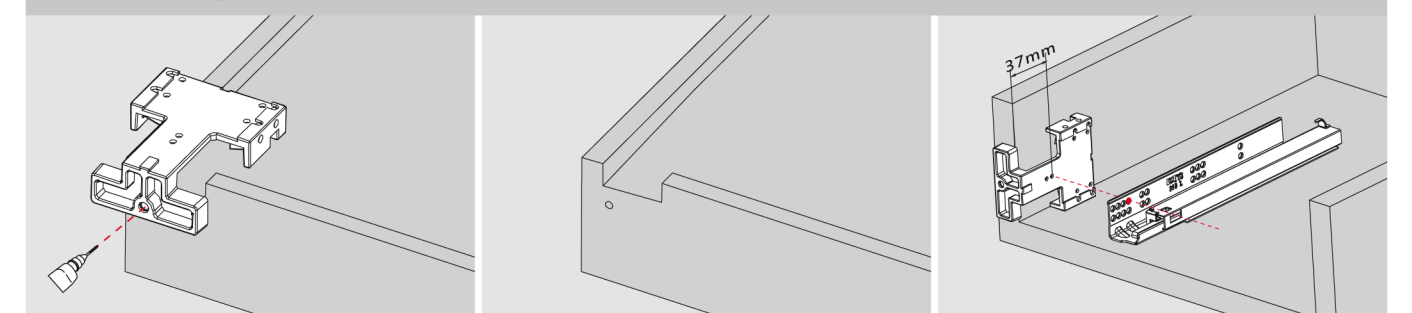

Drill a hole (Φ6, depth 10mm)

mark the position of the fourth hole for standard drawer



BALL BEARING
SLIDES SERIES

SUPER-RAIL

SUPER-RAIL

Built-in soft-close system

Upgrade from
conventional B.B.Slides



- An upgraded slide based on the conventional B.B.Slides by building into the slide a soft-close device.
- Applicable in office, home and other occasions that require full-extension drawers, various sizes available.
- Thanks to the purpose-built reset device, installation is hassle-free.



Quietness



Intelligence



Durability



Eco-Friendliness

SUPER-RAIL

45mm Series Soft-close Round Profile Full Extension Ball Bearing Slides-Metric Sizes



PRODUCT



DESCRIPTION

- Load capacity: 45kg
- Finish: Blue zinc plated(B02), Black(D01)
- Lengths: 250-600mm
- Full extension
- Soft-close
- Single way travel

SPACE REQUIREMENT

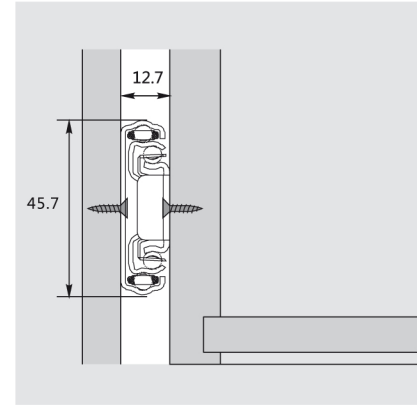

ORDER INFORMATION

Installation Dimensions(mm)

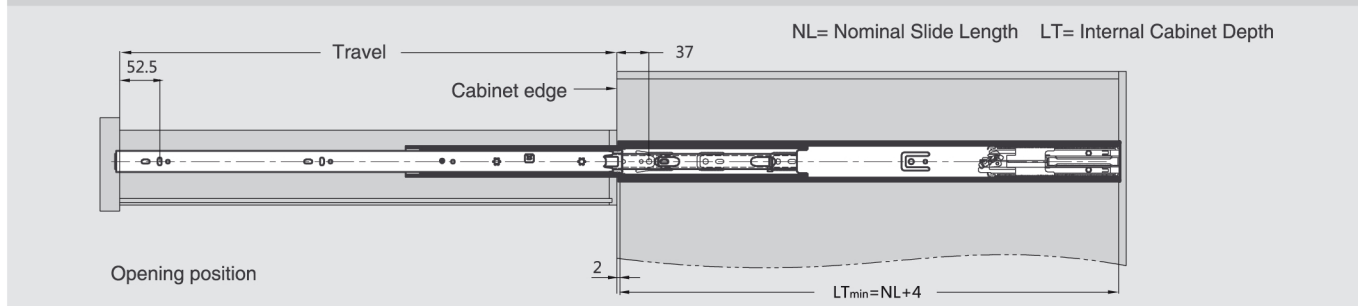

Screw Positions of the Slides(mm)

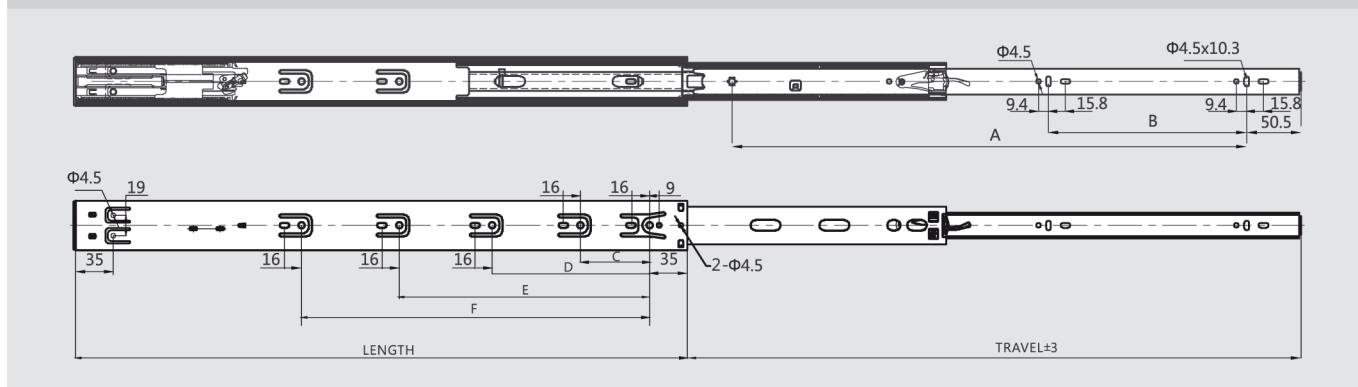

Installation Dimensions(mm)

Item No.	Length NL	Travel	Hole pattern						Set/ctn
			A	B	C	D	E	F	
4587110H	250	163.8	174						12
4587112H	300	263.8	224	64	96				12
4587114H	350	335.3	256	96	64	128			12
4587116H	400	401	320	128	64	128	192		12
4587118H	450	451	352	160	64	128	224		12
4587120H	500	501	416	192	64	128	256		12
4587122H	550	551	448	224	64	128	224	320	12
4587124H	600	601	512	224	64	128	224	352	12

BALL BEARING SLIDES

45mm Series Push-open Round Profile Full Extension Ball Bearing Slides-Metric Sizes



PRODUCT



DESCRIPTION

- Load capacity: 45kg
- Finish: Blue zinc plated(B02), Black(D01)
- Lengths: 300-700mm
- Inner member with mounting tabs
- Soft-close
- Single way travel

SPACE REQUIREMENT

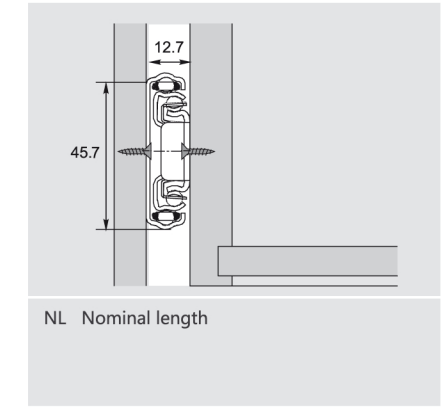

ORDER INFORMATION

Installation Dimensions(mm)

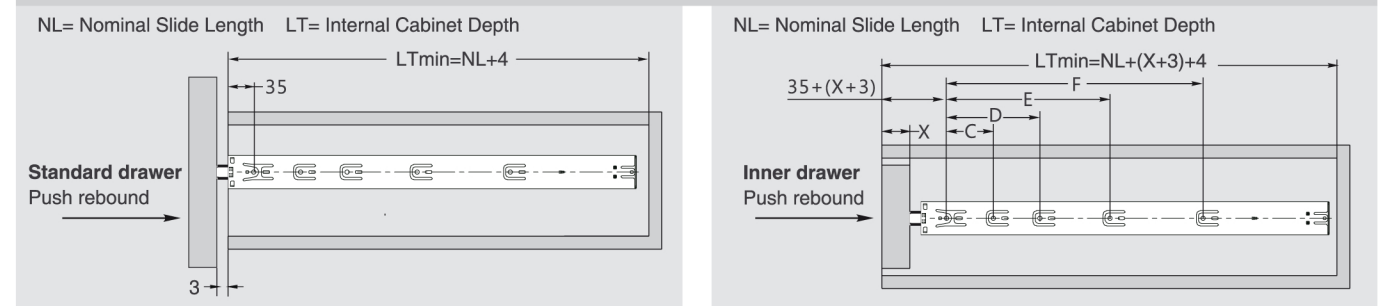

Screw Positions of the Slides(mm)

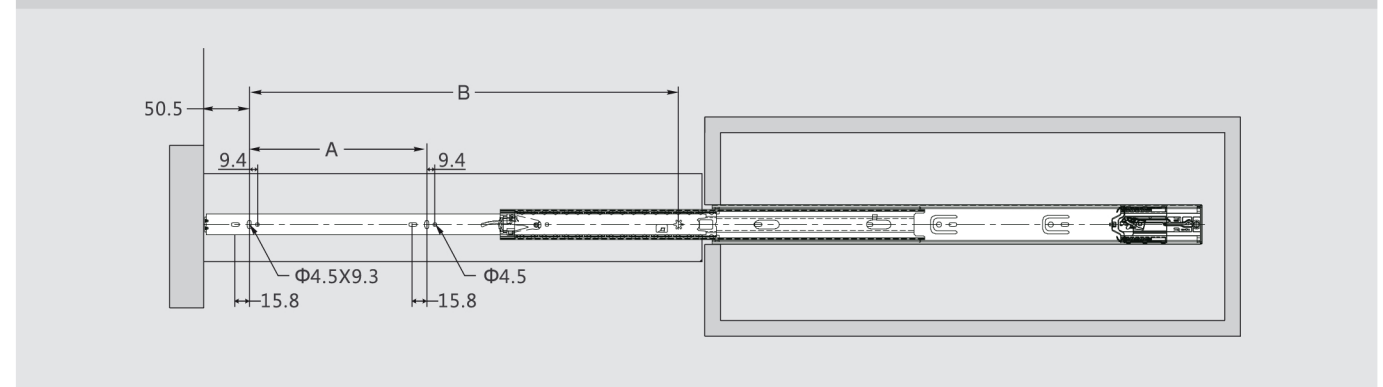

Installation Dimensions(mm)

Item No.	Length NL	Travel	Hole pattern						Set/ctn
			A	B	C	D	E	F	
4587110G	250	163.8	174		64				12
4587112G	300	263.8	64	224	96				12
4587114G	350	335.3	96	224	64	128			12
4587116G	400	401	128	320	64	128	192		12
4587118G	450	451	160	320	64	128	224		12
4587120G	500	501	192	416	64	128	256		12
4587122G	550	551	224	416	64	128	224	320	12
4587124G	600	601	224	512	64	128	224	352	12